

Southwest Harbor

Map Lot 020-002

Account 909

Location

Card 1 Of 1 10/28/2020

Building Style	SF Bsmt Living	Layout
1.Conv. 5.Colonial 9.Other	Fin Bsmt Grade	1.Typical 4. 7.
2.Ranch 6.Split 10.	OPEN 5 OPTIONAL	2.Inadeq 5. 8.
3.R Ranch 7.Contemp 11.	Heat Type 100%	3. 6. 9.
4.Cape 8.Cottage 12.	1.HWBB 5.FWA 9.No Heat	Attic
Dwelling Units	2.HWCI 6.GravWA 10.	1.1/4 Fin 4.Full Fin 7.
Other Units	3.H Pump 7.Electric 11.	2.1/2 Fin 5.F/Stair 8.
Stories	4.Radiant 8.F/Wall 12.	3.3/4 Fin 6. 9.None
1.1 4.1.5 7.3.5	Cool Type 0%	Insulation
2.2 5.1.75 8.4	1.Refrig 4.W&C Air 7.	1.Full 4.Minimal 7.
3.3 6.2.5 9.	2.Evapor 5. 8.	2.Heavy 5. 8.
Exterior Walls	3.H Pump 6. 9.None	3.Capped 6. 9.None
1.Wood 5.Shingle 9.Other	Kitchen Style	Unfinished %
2.Vinyl 6.Brick/St 10.Alum	1.Modern 4.Obsolete 7.	Grade & Factor
3.Compos. 7.Single 11.Log	2.Typical 5. 8.	1.E Grade 4.B Grade 7.3A Grade
4.Asbestos 8.Concrete 12.Stone	3.Old Type 6. 9.None	2.D Grade 5.A Grade 8.M&S Grad
Roof Surface	Bath(s) Style	3.C Grade 6.AA Grade 9.Same
1.Asphalt 4.Composit 7.Rolled R	1.Modern 4.Obsolete 7.	SQFT (Footprint)
2.Slate 5.Wood 8.	2.Typical 5. 8.	Condition
3.Metal 6.Other 9.	3.Old Type 6. 9.None	1.Poor 4.Avg 7.V G
SF Masonry Trim	# Rooms	2.Fair 5.Avg+ 8.Exc
OPEN-3-CUSTOM	# Bedrooms	3.Avg- 6.Good 9.Same
OPEN-4-CUSTOM	# Full Baths	Phys. % Good
Year Built	# Half Baths	Funct. % Good
Year Remodeled	# Addn Fixtures	Functional Code
Foundation	# Fireplaces	1.Incomp 4.Plb/Ht 7.
1.Concrete 4.Wood 7.		2.O-Built 5. 8.FractShr
2.C Block 5.Slab 8.		3.Style 6. 9.None
3.Br/Stone 6.Piers 9.		Econ. % Good
Basement		Economic Code
1.1/4 Bmt 4.Full Bmt 7.		0.None 3.No Power 7.
2.1/2 Bmt 5.Crawl 8.		1.Location 9.None 8.
3.3/4 Bmt 6. 9.None		2.Encroach 6. 9.
Bsmt Gar # Cars		Entrance Code 0
Wet Basement		1.Interior 4.Vacant 7.
1.Dry 4.Dirt Flo 7.		2.Refusal 5.Estimate 8.
2.Damp 5. 8.	3.Informed 6. 9.	
3.Wet 6. 9.	Information Code 0	
	1.Owner 4.Agent 7.	
	2.Relative 5.Estimate 8.	
	3.Tenant 6.Other 9.	

Date Inspected

Additions, Outbuildings & Improvements

Type	Year	Units	Grade	Cond	Phys.	Funct.	Sound Value
					%	%	1.One Story Fram
					%	%	2.Two Story Fram
					%	%	3.Three Story Fr
					%	%	4.1 & 1/2 Story
					%	%	5.1 & 3/4 Story
					%	%	6.2 & 1/2 Story
					%	%	21.Open Frame Por
					%	%	22.Encl Frame Por
					%	%	23.Frame Garage
					%	%	24.Frame Shed
					%	%	25.Finished 1/2 S
					%	%	26.1SFr Overhang
					%	%	27.Unfin Basement
					%	%	28.Unfinished Att
					%	%	29.Finished Attic

ACADIA NATIONAL PARK
C/O BRUCE JACOBSON-PLANNER
P.O. BOX 177
BAR HARBOR ME 04609

Property Data

Neighborhood	1 Neighborhood 1	
Tree Growth Year	0	
X Coordinate	0	
Y Coordinate	0	
Zone/Land Use	48 Waterfront 1	
Secondary Zone		
Topography	2 Rolling	7 Rough
1.Level	4.Below St	7.Rough
2.Rolling	5.Low	8.
3.Above St	6.Swampy	9.
Utilities	9 None	
1.Summer Wtr	4.Dr Well	7.Septic
2.Water	5.Dug Well	8.Spring
3.Sewer	6.Lake Wtr	9.None
Street	1 Paved	
1.Paved	4.Proposed	7.
2.Semi Imp	5.	8.
3.Gravel	6.	9.None
TG PLAN YEAR	5	
	0	
Sale Data		
Sale Date		
Price		
Sale Type		
1.Land	4.Mobile	7.C/I L&B
2.L & B	5.Other	8.
3.Building	6.C/I Land	9.
Financing		
1.Convent	4.Seller	7.
2.FHA/VA	5.Private	8.
3.Assumed	6.Cash	9.Unknown
Validity		
1.Valid	4.Split	7.Renovate
2.Related	5.Partial	8.Other
3.Distress	6.Exempt	9.
Verified		
1.Buyer	4.Agent	7.Family
2.Seller	5.Pub Rec	8.Other
3.Lender	6.MLS	9.

Assessment Record

Year	Land	Buildings	Exempt	Total
2007	0	0	0	0
2008	0	0	0	0
2009	0	0	0	0
2010	0	0	0	0
2011	0	0	0	0
2012	0	0	0	0
2013	0	0	0	0
2014	0	0	0	0
2015	0	0	0	0
2016	0	0	0	0
2017	0	0	0	0
2018	0	0	0	0
2019	0	0	0	0
2020	0	0	0	0

Land Data

Front Foot	Type	Effective		Influence		Influence Codes
		Frontage	Depth	Factor	Code	
11.Regular Lot				%		1.Use
12.Delta Triangle				%		2.R/W
13.Nabla Triangle				%		3.Topography
14.Rear Land				%		4.Size/Shape
15.Miscellaneous				%		5.Access
				%		6.Restriction
				%		7.Vacancy
				%		8.Semi-improved
				%		9.Fract Share
				%		Acres
				%		30.Rear Land 3
				%		31.Rear Land 4
				%		32.Pasture
				%		33.Crop
				%		34.Hortical I
				%		35.Hortical II
				%		36.Ochard
				%		37.Softwood
				%		38.Mixed Wood
				%		39.Hardwood
				%		40.Wasteland
				%		41.Gravel Pit
				%		42.Mobile Home Si
				%		43.Condo Site
				%		44.Lot Improvemen
				%		45.Mobile Home Ho
				%		46.Golf Course
Square Foot		Square Feet				
16.Regular Lot				%		
17.Secondary Lot				%		
18.Hydro Facility				%		
19.Improvements				%		
20.Miscellaneous				%		
Fract. Acre		Acreage/Sites				
21.Homesite (Fract)				%		
22.Baselot (Fract)				%		
23.Misc (Fract)				%		
Acres				%		
24.Homesite				%		
25.Baselot				%		
26.Frontage 1				%		
27.Frontage 2				%		
28.Rear Land 1				%		
29.Rear Land 2				%		
Total Acreage				0.00		

Inspection Witnessed By:

No./Date	Description	Date Insp.
X		

Notes:

Southwest Harbor

Southwest Harbor

Map Lot 020-003

Account 913

Location

Card 1 Of 1 10/28/2020

Building Style	SF Bsmt Living	Layout
1.Conv. 5.Colonial 9.Other	Fin Bsmt Grade	1.Typical 4. 7.
2.Ranch 6.Split 10.	OPEN 5 OPTIONAL	2.Inadeq 5. 8.
3.R Ranch 7.Contemp 11.	Heat Type 100%	3. 6. 9.
4.Cape 8.Cottage 12.	1.HWBB 5.FWA 9.No Heat	Attic
Dwelling Units	2.HWCI 6.GravWA 10.	1.1/4 Fin 4.Full Fin 7.
Other Units	3.H Pump 7.Electric 11.	2.1/2 Fin 5.F/Stair 8.
Stories	4.Radiant 8.F/Wall 12.	3.3/4 Fin 6. 9.None
1.1 4.1.5 7.3.5	Cool Type 0%	Insulation
2.2 5.1.75 8.4	1.Refrig 4.W&C Air 7.	1.Full 4.Minimal 7.
3.3 6.2.5 9.	2.Evapor 5. 8.	2.Heavy 5. 8.
Exterior Walls	3.H Pump 6. 9.None	3.Capped 6. 9.None
1.Wood 5.Shingle 9.Other	Kitchen Style	Unfinished %
2.Vinyl 6.Brick/St 10.Alum	1.Modern 4.Obsolete 7.	Grade & Factor
3.Compos. 7.Single 11.Log	2.Typical 5. 8.	1.E Grade 4.B Grade 7.3A Grade
4.Asbestos 8.Concrete 12.Stone	3.Old Type 6. 9.None	2.D Grade 5.A Grade 8.M&S Grad
Roof Surface	Bath(s) Style	3.C Grade 6.AA Grade 9.Same
1.Asphalt 4.Composit 7.Rolled R	1.Modern 4.Obsolete 7.	SQFT (Footprint)
2.Slate 5.Wood 8.	2.Typical 5. 8.	Condition
3.Metal 6.Other 9.	3.Old Type 6. 9.None	1.Poor 4.Avg 7.V G
SF Masonry Trim	# Rooms	2.Fair 5.Avg+ 8.Exc
OPEN-3-CUSTOM	# Bedrooms	3.Avg- 6.Good 9.Same
OPEN-4-CUSTOM	# Full Baths	Phys. % Good
Year Built	# Half Baths	Funct. % Good
Year Remodeled	# Addn Fixtures	Functional Code
Foundation	# Fireplaces	1.Incomp 4.Plb/Ht 7.
1.Concrete 4.Wood 7.		2.O-Built 5. 8.FractShr
2.C Block 5.Slab 8.		3.Style 6. 9.None
3.Br/Stone 6.Piers 9.		Econ. % Good
Basement		Economic Code
1.1/4 Bmt 4.Full Bmt 7.		0.None 3.No Power 7.
2.1/2 Bmt 5.Crawl 8.		1.Location 9.None 8.
3.3/4 Bmt 6. 9.None		2.Encroach 6. 9.
Bsmt Gar # Cars		Entrance Code 0
Wet Basement		1.Interior 4.Vacant 7.
1.Dry 4.Dirt Flo 7.		2.Refusal 5.Estimate 8.
2.Damp 5. 8.	3.Informed 6. 9.	
3.Wet 6. 9.	Information Code 0	
	1.Owner 4.Agent 7.	
	2.Relative 5.Estimate 8.	
	3.Tenant 6.Other 9.	

Date Inspected

Additions, Outbuildings & Improvements

Type	Year	Units	Grade	Cond	Phys.	Funct.	Sound Value
					%	%	1.One Story Fram
					%	%	2.Two Story Fram
					%	%	3.Three Story Fr
					%	%	4.1 & 1/2 Story
					%	%	5.1 & 3/4 Story
					%	%	6.2 & 1/2 Story
					%	%	21.Open Frame Por
					%	%	22.Encl Frame Por
					%	%	23.Frame Garage
					%	%	24.Frame Shed
					%	%	25.Finished 1/2 S
					%	%	26.1SFr Overhang
					%	%	27.Unfin Basement
					%	%	28.Unfinished Att
					%	%	29.Finished Attic

CLARK, ERIC
PO BOX 1512
SOUTHWEST HARBOR ME 04679

B4926P61

Previous Owner
GOTT, TIMOTHY H.
110 BASS HARBOR ROAD

SOUTHWEST HARBOR, ME 04679
Sale Date: 1/22/2008

Inspection Witnessed By:

No./Date	Description	Date Insp.
X		

Notes:

Southwest Harbor

Property Data			Assessment Record						
Neighborhood	1 Neighborhood 1		Year	Land	Buildings	Exempt	Total		
Tree Growth Year	0		2007	105,700	0	0	105,700		
X Coordinate	0		2008	105,700	0	0	105,700		
Y Coordinate	0		2009	105,700	0	0	105,700		
Zone/Land Use	11 Residential 1		2010	89,800	0	0	89,800		
Secondary Zone			2011	89,800	0	0	89,800		
Topography	2 Rolling	7 Rough	2012	79,300	0	0	79,300		
1.Level	4.Below St	7.Rough	2013	79,300	0	0	79,300		
2.Rolling	5.Low	8.	2014	79,300	0	0	79,300		
3.Above St	6.Swampy	9.	2015	79,300	0	0	79,300		
Utilities	9 None		2016	79,300	0	0	79,300		
1.Summer Wtr	4.Dr Well	7.Septic	2017	79,300	0	0	79,300		
2.Water	5.Dug Well	8.Spring	2018	79,300	0	0	79,300		
3.Sewer	6.Lake Wtr	9.None	2019	79,300	0	0	79,300		
Street	9 None		2020	79,300	0	0	79,300		
1.Paved	4.Proposed	7.	Land Data						
2.Semi Imp	5.	8.							
3.Gravel	6.	9.None	Front Foot	Type	Effective		Influence		Influence Codes
TG PLAN YEAR	0		11.Regular Lot		Frontage	Depth	Factor	Code	
Sale Data			12.Delta Triangle						1.Use
Sale Date	1/22/2008		13.Nabla Triangle						2.R/W
Price	40,000		14.Rear Land						3.Topography
Sale Type	1 Land Only		15.Miscellaneous						4.Size/Shape
1.Land	4.Mobile	7.C/I L&B	Square Foot		Square Feet				5.Access
2.L & B	5.Other	8.	16.Regular Lot						6.Restriction
3.Building	6.C/I Land	9.	17.Secondary Lot						7.Vacancy
Financing	9 Unknown		18.Hydro Facility						8.Semi-improved
1.Convent	4.Seller	7.	19.Improvements						9.Fract Share
2.FHA/VA	5.Private	8.	20.Miscellaneous						Acres
3.Assumed	6.Cash	9.Unknown	Fract. Acre		Acres/Sites				30.Rear Land 3
Validity	1 Arms Length Sale		21.Homesite (Fract)	22	0.50	50	%	5	31.Rear Land 4
1.Valid	4.Split	7.Renovate	22.Baselot (Fract)	28	5.00	75	%	3	32.Pasture
2.Related	5.Partial	8.Other	23.Misc (Fract)	29	4.30	100	%	0	33.Crop
3.Distress	6.Exempt	9.	Acres						34.Hortical I
Verified	1 Buyer		24.Homesite						35.Hortical II
1.Buyer	4.Agent	7.Family	25.Baselot						36.Orchard
2.Seller	5.Pub Rec	8.Other	26.Frontage 1						37.Softwood
3.Lender	6.MLS	9.	27.Frontage 2						38.Mixed Wood
			28.Rear Land 1						39.Hardwood
			29.Rear Land 2						40.Wasteland
			Total Acreage		9.80				41.Gravel Pit
									42.Mobile Home Si
									43.Condo Site
									44.Lot Improvemen
									45.Mobile Home Ho
									46.Golf Course

Southwest Harbor

Map Lot 020-003-1

Account 1637

Location

Card 1 Of 1 10/28/2020

Building Style	SF Bsmt Living	Layout
1.Conv. 5.Colonial 9.Other	Fin Bsmt Grade	1.Typical 4. 7.
2.Ranch 6.Split 10.	OPEN 5 OPTIONAL	2.Inadeq 5. 8.
3.R Ranch 7.Contemp 11.	Heat Type 100%	3. 6. 9.
4.Cape 8.Cottage 12.	1.HWBB 5.FWA 9.No Heat	Attic
Dwelling Units	2.HWCI 6.GravWA 10.	1.1/4 Fin 4.Full Fin 7.
Other Units	3.H Pump 7.Electric 11.	2.1/2 Fin 5.F/Stair 8.
Stories	4.Radiant 8.F/Wall 12.	3.3/4 Fin 6. 9.None
1.1 4.1.5 7.3.5	Cool Type 0%	Insulation
2.2 5.1.75 8.4	1.Refrig 4.W&C Air 7.	1.Full 4.Minimal 7.
3.3 6.2.5 9.	2.Evapor 5. 8.	2.Heavy 5. 8.
Exterior Walls	3.H Pump 6. 9.None	3.Capped 6. 9.None
1.Wood 5.Shingle 9.Other	Kitchen Style	Unfinished %
2.Vinyl 6.Brick/St 10.Alum	1.Modern 4.Obsolete 7.	Grade & Factor
3.Compos. 7.Single 11.Log	2.Typical 5. 8.	1.E Grade 4.B Grade 7.3A Grade
4.Asbestos 8.Concrete 12.Stone	3.Old Type 6. 9.None	2.D Grade 5.A Grade 8.M&S Grad
Roof Surface	Bath(s) Style	3.C Grade 6.AA Grade 9.Same
1.Asphalt 4.Composit 7.Rolled R	1.Modern 4.Obsolete 7.	SQFT (Footprint)
2.Slate 5.Wood 8.	2.Typical 5. 8.	Condition
3.Metal 6.Other 9.	3.Old Type 6. 9.None	1.Poor 4.Avg 7.V G
SF Masonry Trim	# Rooms	2.Fair 5.Avg+ 8.Exc
OPEN-3-CUSTOM	# Bedrooms	3.Avg- 6.Good 9.Same
OPEN-4-CUSTOM	# Full Baths	Phys. % Good
Year Built	# Half Baths	Funct. % Good
Year Remodeled	# Addn Fixtures	Functional Code
Foundation	# Fireplaces	1.Incomp 4.Plb/Ht 7.
1.Concrete 4.Wood 7.		2.O-Built 5. 8.FractShr
2.C Block 5.Slab 8.		3.Style 6. 9.None
3.Br/Stone 6.Piers 9.		Econ. % Good
Basement		Economic Code
1.1/4 Bmt 4.Full Bmt 7.		0.None 3.No Power 7.
2.1/2 Bmt 5.Crawl 8.		1.Location 9.None 8.
3.3/4 Bmt 6. 9.None		2.Encroach 6. 9.
Bsmt Gar # Cars		Entrance Code 0
Wet Basement		1.Interior 4.Vacant 7.
1.Dry 4.Dirt Flo 7.		2.Refusal 5.Estimate 8.
2.Damp 5. 8.	3.Informed 6. 9.	
3.Wet 6. 9.	Information Code 0	
	1.Owner 4.Agent 7.	
	2.Relative 5.Estimate 8.	
	3.Tenant 6.Other 9.	

Date Inspected

Additions, Outbuildings & Improvements

Type	Year	Units	Grade	Cond	Phys.	Funct.	Sound Value
					%	%	1.One Story Fram
					%	%	2.Two Story Fram
					%	%	3.Three Story Fr
					%	%	4.1 & 1/2 Story
					%	%	5.1 & 3/4 Story
					%	%	6.2 & 1/2 Story
					%	%	21.Open Frame Por
					%	%	22.Encl Frame Por
					%	%	23.Frame Garage
					%	%	24.Frame Shed
					%	%	25.Finished 1/2 S
					%	%	26.1SFr Overhang
					%	%	27.Unfin Basement
					%	%	28.Unfinished Att
					%	%	29.Finished Attic

Southwest Harbor

Map Lot 020-004

Account 533

Location TREMONT BORDER

Card 1 Of 1 10/28/2020

Building Style	SF Bsmt Living	Layout
1.Conv. 5.Colonial 9.Other	Fin Bsmt Grade	1.Typical 4. 7.
2.Ranch 6.Split 10.	OPEN 5 OPTIONAL	2.Inadeq 5. 8.
3.R Ranch 7.Contemp 11.	Heat Type 100%	3. 6. 9.
4.Cape 8.Cottage 12.	1.HWBB 5.FWA 9.No Heat	Attic
Dwelling Units	2.HWCI 6.GravWA 10.	1.1/4 Fin 4.Full Fin 7.
Other Units	3.H Pump 7.Electric 11.	2.1/2 Fin 5.F/Stair 8.
Stories	4.Radiant 8.F/Wall 12.	3.3/4 Fin 6. 9.None
1.1 4.1.5 7.3.5	Cool Type 0%	Insulation
2.2 5.1.75 8.4	1.Refrig 4.W&C Air 7.	1.Full 4.Minimal 7.
3.3 6.2.5 9.	2.Evapor 5. 8.	2.Heavy 5. 8.
Exterior Walls	3.H Pump 6. 9.None	3.Capped 6. 9.None
1.Wood 5.Shingle 9.Other	Kitchen Style	Unfinished %
2.Vinyl 6.Brick/St 10.Alum	1.Modern 4.Obsolete 7.	Grade & Factor
3.Compos. 7.Single 11.Log	2.Typical 5. 8.	1.E Grade 4.B Grade 7.3A Grade
4.Asbestos 8.Concrete 12.Stone	3.Old Type 6. 9.None	2.D Grade 5.A Grade 8.M&S Grad
Roof Surface	Bath(s) Style	3.C Grade 6.AA Grade 9.Same
1.Asphalt 4.Composit 7.Rolled R	1.Modern 4.Obsolete 7.	SQFT (Footprint)
2.Slate 5.Wood 8.	2.Typical 5. 8.	Condition
3.Metal 6.Other 9.	3.Old Type 6. 9.None	1.Poor 4.Avg 7.V G
SF Masonry Trim	# Rooms	2.Fair 5.Avg+ 8.Exc
OPEN-3-CUSTOM	# Bedrooms	3.Avg- 6.Good 9.Same
OPEN-4-CUSTOM	# Full Baths	Phys. % Good
Year Built	# Half Baths	Funct. % Good
Year Remodeled	# Addn Fixtures	Functional Code
Foundation	# Fireplaces	1.Incomp 4.Plb/Ht 7.
1.Concrete 4.Wood 7.		2.O-Built 5. 8.FractShr
2.C Block 5.Slab 8.		3.Style 6. 9.None
3.Br/Stone 6.Piers 9.		Econ. % Good
Basement		Economic Code
1.1/4 Bmt 4.Full Bmt 7.		0.None 3.No Power 7.
2.1/2 Bmt 5.Crawl 8.		1.Location 9.None 8.
3.3/4 Bmt 6. 9.None		2.Encroach 6. 9.
Bsmt Gar # Cars		Entrance Code 0
Wet Basement		1.Interior 4.Vacant 7.
1.Dry 4.Dirt Flo 7.		2.Refusal 5.Estimate 8.
2.Damp 5. 8.	3.Informed 6. 9.	
3.Wet 6. 9.	Information Code 0	
	1.Owner 4.Agent 7.	
	2.Relative 5.Estimate 8.	
	3.Tenant 6.Other 9.	

Date Inspected

Additions, Outbuildings & Improvements

Type	Year	Units	Grade	Cond	Phys.	Funct.	Sound Value
					%	%	1.One Story Fram
					%	%	2.Two Story Fram
					%	%	3.Three Story Fr
					%	%	4.1 & 1/2 Story
					%	%	5.1 & 3/4 Story
					%	%	6.2 & 1/2 Story
					%	%	21.Open Frame Por
					%	%	22.Encl Frame Por
					%	%	23.Frame Garage
					%	%	24.Frame Shed
					%	%	25.Finished 1/2 S
					%	%	26.1SFr Overhang
					%	%	27.Unfin Basement
					%	%	28.Unfinished Att
					%	%	29.Finished Attic

Southwest Harbor

Map Lot 020-005

Account 921

Location ANP

Card 1 Of 1 10/28/2020

Building Style	SF Bsmt Living	Layout
1.Conv. 5.Colonial 9.Other	Fin Bsmt Grade	1.Typical 4. 7.
2.Ranch 6.Split 10.	OPEN 5 OPTIONAL	2.Inadeq 5. 8.
3.R Ranch 7.Contemp 11.	Heat Type 100%	3. 6. 9.
4.Cape 8.Cottage 12.	1.HWBB 5.FWA 9.No Heat	Attic
Dwelling Units	2.HWCI 6.GravWA 10.	1.1/4 Fin 4.Full Fin 7.
Other Units	3.H Pump 7.Electric 11.	2.1/2 Fin 5.F/Stair 8.
Stories	4.Radiant 8.F/Wall 12.	3.3/4 Fin 6. 9.None
1.1 4.1.5 7.3.5	Cool Type 0%	Insulation
2.2 5.1.75 8.4	1.Refrig 4.W&C Air 7.	1.Full 4.Minimal 7.
3.3 6.2.5 9.	2.Evapor 5. 8.	2.Heavy 5. 8.
Exterior Walls	3.H Pump 6. 9.None	3.Capped 6. 9.None
1.Wood 5.Shingle 9.Other	Kitchen Style	Unfinished %
2.Vinyl 6.Brick/St 10.Alum	1.Modern 4.Obsolete 7.	Grade & Factor
3.Compos. 7.Single 11.Log	2.Typical 5. 8.	1.E Grade 4.B Grade 7.3A Grade
4.Asbestos 8.Concrete 12.Stone	3.Old Type 6. 9.None	2.D Grade 5.A Grade 8.M&S Grad
Roof Surface	Bath(s) Style	3.C Grade 6.AA Grade 9.Same
1.Asphalt 4.Composit 7.Rolled R	1.Modern 4.Obsolete 7.	SQFT (Footprint)
2.Slate 5.Wood 8.	2.Typical 5. 8.	Condition
3.Metal 6.Other 9.	3.Old Type 6. 9.None	1.Poor 4.Avg 7.V G
SF Masonry Trim	# Rooms	2.Fair 5.Avg+ 8.Exc
OPEN-3-CUSTOM	# Bedrooms	3.Avg- 6.Good 9.Same
OPEN-4-CUSTOM	# Full Baths	Phys. % Good
Year Built	# Half Baths	Funct. % Good
Year Remodeled	# Addn Fixtures	Functional Code
Foundation	# Fireplaces	1.Incomp 4.Plb/Ht 7.
1.Concrete 4.Wood 7.		2.O-Built 5. 8.FractShr
2.C Block 5.Slab 8.		3.Style 6. 9.None
3.Br/Stone 6.Piers 9.		Econ. % Good
Basement		Economic Code
1.1/4 Bmt 4.Full Bmt 7.		0.None 3.No Power 7.
2.1/2 Bmt 5.Crawl 8.		1.Location 9.None 8.
3.3/4 Bmt 6. 9.None		2.Encroach 6. 9.
Bsmt Gar # Cars		Entrance Code 0
Wet Basement		1.Interior 4.Vacant 7.
1.Dry 4.Dirt Flo 7.		2.Refusal 5.Estimate 8.
2.Damp 5. 8.	3.Informed 6. 9.	
3.Wet 6. 9.	Information Code 0	
	1.Owner 4.Agent 7.	
	2.Relative 5.Estimate 8.	
	3.Tenant 6.Other 9.	

Date Inspected

Additions, Outbuildings & Improvements

Type	Year	Units	Grade	Cond	Phys.	Funct.	Sound Value
					%	%	1.One Story Fram
					%	%	2.Two Story Fram
					%	%	3.Three Story Fr
					%	%	4.1 & 1/2 Story
					%	%	5.1 & 3/4 Story
					%	%	6.2 & 1/2 Story
					%	%	21.Open Frame Por
					%	%	22.Encl Frame Por
					%	%	23.Frame Garage
					%	%	24.Frame Shed
					%	%	25.Finished 1/2 S
					%	%	26.1SFr Overhang
					%	%	27.Unfin Basement
					%	%	28.Unfinished Att
					%	%	29.Finished Attic

CHALMERS, DANIEL O
CHALMERS, RITA A
298 SEAWALL ROAD
SOUTHWEST HARBOR ME 04679

Previous Owner
CHALMERS, DANIEL O.
CHALMERS, RITA A.
298 SEAWALL ROAD
SOUTHWEST HARBOR, ME 04679
Sale Date: 10/29/2013

Inspection Witnessed By:

X		Date
No./Date	Description	Date Insp.

Notes:

Southwest Harbor

Property Data			Assessment Record				
Neighborhood 1 Neighborhood 1			Year	Land	Buildings	Exempt	Total
Tree Growth Year 0			2007	18,400	0	0	18,400
X Coordinate 0			2008	18,400	0	0	18,400
Y Coordinate 0			2009	18,400	0	0	18,400
Zone/Land Use 11 Residential 1			2010	15,600	0	0	15,600
Secondary Zone			2011	15,600	0	0	15,600
Topography 2 Rolling 7 Rough			2012	13,800	0	0	13,800
1.Level 4.Below St 7.Rough			2013	13,800	0	0	13,800
2.Rolling 5.Low 8.			2014	13,800	0	0	13,800
3.Above St 6.Swampy 9.			2015	13,800	0	0	13,800
Utilities 9 None			2016	13,800	0	0	13,800
1.Summer Wtr 4.Dr Well 7.Septic			2017	13,800	0	0	13,800
2.Water 5.Dug Well 8.Spring			2018	13,800	0	0	13,800
3.Sewer 6.Lake Wtr 9.None			2019	13,800	0	0	13,800
Street 9 None			2020	13,800	0	0	13,800
1.Paved 4.Proposed 7.			Land Data				
2.Semi Imp 5. 8.							
3.Gravel 6. 9.None			Front Foot				
TG PLAN YEAR 7							
Sale Date			Square Foot				
Price							
Sale Type 1 Land Only			Fract. Acre				
1.Land 4.Mobile 7.C/I L&B							
2.L & B 5.Other 8.			Acres				
3.Building 6.C/I Land 9.							
Financing 9 Unknown			Acres				
1.Convent 4.Seller 7.							
2.FHA/VA 5.Private 8.			Acres				
3.Assumed 6.Cash 9.Unknown							
Validity 4 Split/Assemblage			Acres				
1.Valid 4.Split 7.Renovate							
2.Related 5.Partial 8.Other			Acres				
3.Distress 6.Exempt 9.							
Verified 1 Buyer			Acres				
1.Buyer 4.Agent 7.Family							
2.Seller 5.Pub Rec 8.Other			Acres				
3.Lender 6.MLS 9.							

Type	Effective		Influence		Influence Codes
	Frontage	Depth	Factor	Code	
11.Regular Lot			%		1.Use
12.Delta Triangle			%		2.R/W
13.Nabla Triangle			%		3.Topography
14.Rear Land			%		4.Size/Shape
15.Miscellaneous			%		5.Access
			%		6.Restriction
			%		7.Vacancy
			%		8.Semi-improved
			%		9.Fract Share
			%		Acres
			%		30.Rear Land 3
			%		31.Rear Land 4
			%		32.Pasture
			%		33.Crop
			%		34.Hortical I
			%		35.Hortical II
			%		36.Orchard
			%		37.Softwood
			%		38.Mixed Wood
			%		39.Hardwood
			%		40.Wasteland
			%		41.Gravel Pit
			%		42.Mobile Home Si
			%		43.Condo Site
			%		44.Lot Improvemen
			%		45.Mobile Home Ho
			%		46.Golf Course
Total Acreage			33.47		

Southwest Harbor

Map Lot 020-006

Account 948

Location SEAWALL ROAD - NROW

Card 1 Of 1 10/28/2020

Building Style	SF Bsmt Living	Layout
1.Conv. 5.Colonial 9.Other	Fin Bsmt Grade	1.Typical 4. 7.
2.Ranch 6.Split 10.	OPEN 5 OPTIONAL	2.Inadeq 5. 8.
3.R Ranch 7.Contemp 11.	Heat Type 100%	3. 6. 9.
4.Cape 8.Cottage 12.	1.HWBB 5.FWA 9.No Heat	Attic
Dwelling Units	2.HWCI 6.GravWA 10.	1.1/4 Fin 4.Full Fin 7.
Other Units	3.H Pump 7.Electric 11.	2.1/2 Fin 5.F/Stair 8.
Stories	4.Radiant 8.F/Wall 12.	3.3/4 Fin 6. 9.None
1.1 4.1.5 7.3.5	Cool Type 0%	Insulation
2.2 5.1.75 8.4	1.Refrig 4.W&C Air 7.	1.Full 4.Minimal 7.
3.3 6.2.5 9.	2.Evapor 5. 8.	2.Heavy 5. 8.
Exterior Walls	3.H Pump 6. 9.None	3.Capped 6. 9.None
1.Wood 5.Shingle 9.Other	Kitchen Style	Unfinished %
2.Vinyl 6.Brick/St 10.Alum	1.Modern 4.Obsolete 7.	Grade & Factor
3.Compos. 7.Single 11.Log	2.Typical 5. 8.	1.E Grade 4.B Grade 7.3A Grade
4.Asbestos 8.Concrete 12.Stone	3.Old Type 6. 9.None	2.D Grade 5.A Grade 8.M&S Grad
Roof Surface	Bath(s) Style	3.C Grade 6.AA Grade 9.Same
1.Asphalt 4.Composit 7.Rolled R	1.Modern 4.Obsolete 7.	SQFT (Footprint)
2.Slate 5.Wood 8.	2.Typical 5. 8.	Condition
3.Metal 6.Other 9.	3.Old Type 6. 9.None	1.Poor 4.Avg 7.V G
SF Masonry Trim	# Rooms	2.Fair 5.Avg+ 8.Exc
OPEN-3-CUSTOM	# Bedrooms	3.Avg- 6.Good 9.Same
OPEN-4-CUSTOM	# Full Baths	Phys. % Good
Year Built	# Half Baths	Funct. % Good
Year Remodeled	# Addn Fixtures	Functional Code
Foundation	# Fireplaces	1.Incomp 4.Plb/Ht 7.
1.Concrete 4.Wood 7.		2.O-Built 5. 8.FractShr
2.C Block 5.Slab 8.		3.Style 6. 9.None
3.Br/Stone 6.Piers 9.		Econ. % Good
Basement		Economic Code
1.1/4 Bmt 4.Full Bmt 7.		0.None 3.No Power 7.
2.1/2 Bmt 5.Crawl 8.		1.Location 9.None 8.
3.3/4 Bmt 6. 9.None		2.Encroach 6. 9.
Bsmt Gar # Cars		Entrance Code 0
Wet Basement		1.Interior 4.Vacant 7.
1.Dry 4.Dirt Flo 7.		2.Refusal 5.Estimate 8.
2.Damp 5. 8.	3.Informed 6. 9.	
3.Wet 6. 9.	Information Code 0	
	1.Owner 4.Agent 7.	
	2.Relative 5.Estimate 8.	
	3.Tenant 6.Other 9.	

Date Inspected

Additions, Outbuildings & Improvements

Type	Year	Units	Grade	Cond	Phys.	Funct.	Sound Value
					%	%	1.One Story Fram
					%	%	2.Two Story Fram
					%	%	3.Three Story Fr
					%	%	4.1 & 1/2 Story
					%	%	5.1 & 3/4 Story
					%	%	6.2 & 1/2 Story
					%	%	21.Open Frame Por
					%	%	22.Encl Frame Por
					%	%	23.Frame Garage
					%	%	24.Frame Shed
					%	%	25.Finished 1/2 S
					%	%	26.1SFr Overhang
					%	%	27.Unfin Basement
					%	%	28.Unfinished Att
					%	%	29.Finished Attic

Southwest Harbor

Map Lot 020-006-001

Account 1402

Location

Card 1 Of 1 10/28/2020

Building Style	SF Bsmt Living	Layout
1.Conv. 5.Colonial 9.Other	Fin Bsmt Grade	1.Typical 4. 7.
2.Ranch 6.Split 10.	OPEN 5 OPTIONAL	2.Inadeq 5. 8.
3.R Ranch 7.Contemp 11.	Heat Type 100%	3. 6. 9.
4.Cape 8.Cottage 12.	1.HWBB 5.FWA 9.No Heat	Attic
Dwelling Units	2.HWCI 6.GravWA 10.	1.1/4 Fin 4.Full Fin 7.
Other Units	3.H Pump 7.Electric 11.	2.1/2 Fin 5.F/Stair 8.
Stories	4.Radiant 8.F/Wall 12.	3.3/4 Fin 6. 9.None
1.1 4.1.5 7.3.5	Cool Type 0%	Insulation
2.2 5.1.75 8.4	1.Refrig 4.W&C Air 7.	1.Full 4.Minimal 7.
3.3 6.2.5 9.	2.Evapor 5. 8.	2.Heavy 5. 8.
Exterior Walls	3.H Pump 6. 9.None	3.Capped 6. 9.None
1.Wood 5.Shingle 9.Other	Kitchen Style	Unfinished %
2.Vinyl 6.Brick/St 10.Alum	1.Modern 4.Obsolete 7.	Grade & Factor
3.Compos. 7.Single 11.Log	2.Typical 5. 8.	1.E Grade 4.B Grade 7.3A Grade
4.Asbestos 8.Concrete 12.Stone	3.Old Type 6. 9.None	2.D Grade 5.A Grade 8.M&S Grad
Roof Surface	Bath(s) Style	3.C Grade 6.AA Grade 9.Same
1.Asphalt 4.Composit 7.Rolled R	1.Modern 4.Obsolete 7.	SQFT (Footprint)
2.Slate 5.Wood 8.	2.Typical 5. 8.	Condition
3.Metal 6.Other 9.	3.Old Type 6. 9.None	1.Poor 4.Avg 7.V G
SF Masonry Trim	# Rooms	2.Fair 5.Avg+ 8.Exc
OPEN-3-CUSTOM	# Bedrooms	3.Avg- 6.Good 9.Same
OPEN-4-CUSTOM	# Full Baths	Phys. % Good
Year Built	# Half Baths	Funct. % Good
Year Remodeled	# Addn Fixtures	Functional Code
Foundation	# Fireplaces	1.Incomp 4.Plb/Ht 7.
1.Concrete 4.Wood 7.		2.O-Built 5. 8.FractShr
2.C Block 5.Slab 8.		3.Style 6. 9.None
3.Br/Stone 6.Piers 9.		Econ. % Good
Basement		Economic Code
1.1/4 Bmt 4.Full Bmt 7.		0.None 3.No Power 7.
2.1/2 Bmt 5.Crawl 8.		1.Location 9.None 8.
3.3/4 Bmt 6. 9.None		2.Encroach 6. 9.
Bsmt Gar # Cars		Entrance Code 0
Wet Basement		1.Interior 4.Vacant 7.
1.Dry 4.Dirt Flo 7.		2.Refusal 5.Estimate 8.
2.Damp 5. 8.	3.Informed 6. 9.	
3.Wet 6. 9.	Information Code 0	
	1.Owner 4.Agent 7.	
	2.Relative 5.Estimate 8.	
	3.Tenant 6.Other 9.	

Date Inspected

Additions, Outbuildings & Improvements

Type	Year	Units	Grade	Cond	Phys.	Funct.	Sound Value
					%	%	1.One Story Fram
					%	%	2.Two Story Fram
					%	%	3.Three Story Fr
					%	%	4.1 & 1/2 Story
					%	%	5.1 & 3/4 Story
					%	%	6.2 & 1/2 Story
					%	%	21.Open Frame Por
					%	%	22.Encl Frame Por
					%	%	23.Frame Garage
					%	%	24.Frame Shed
					%	%	25.Finished 1/2 S
					%	%	26.1SFr Overhang
					%	%	27.Unfin Basement
					%	%	28.Unfinished Att
					%	%	29.Finished Attic

ISLAND LAND CORP.
C/O B.C. WORCESTER, JR
P.O. BOX 787
SOUTHWEST HARBOR ME 04679 0787

B1359P56

Inspection Witnessed By:

X	Date	Date Insp.
No./Date	Description	Date Insp.

Notes:
'10 REFILED TG , NOTICED CPU ENTRY ERROR ALL PRICED AS REAR 4 IN ERROR NOT TG

Southwest Harbor

Property Data			Assessment Record						
Neighborhood 1 Neighborhood 1			Year	Land	Buildings	Exempt	Total		
Tree Growth Year 0			2007	55,800	0	0	55,800		
X Coordinate 0			2008	55,800	0	0	55,800		
Y Coordinate 0			2009	55,800	0	0	55,800		
Zone/Land Use 11 Residential 1			2010	14,900	0	0	14,900		
Secondary Zone			2011	16,600	0	0	16,600		
Topography 2 Rolling 7 Rough			2012	16,600	0	0	16,600		
1.Level 4.Below St 7.Rough			2013	16,600	0	0	16,600		
2.Rolling 5.Low 8.			2014	17,600	0	0	17,600		
3.Above St 6.Swampy 9.			2015	17,400	0	0	17,400		
Utilities 9 None			2016	21,500	0	0	21,500		
1.Summer Wtr 4.Dr Well 7.Septic			2017	22,500	0	0	22,500		
2.Water 5.Dug Well 8.Spring			2018	22,100	0	0	22,100		
3.Sewer 6.Lake Wtr 9.None			2019	20,500	0	0	20,500		
Street 9 None			2020	19,400	0	0	19,400		
1.Paved 4.Proposed 7.			Land Data						
2.Semi Imp 5. 8.									
3.Gravel 6. 9.None			Front Foot	Type	Effective		Influence		Influence Codes
TG PLAN YEAR 7			11.Regular Lot		Frontage	Depth	Factor	Code	
0			12.Delta Triangle				%		1.Use
Sale Data			13.Nabla Triangle				%		2.R/W
Sale Date			14.Rear Land				%		3.Topography
Price			15.Miscellaneous				%		4.Size/Shape
Sale Type							%		5.Access
1.Land 4.Mobile 7.C/I L&B			Square Foot	Square Feet					6.Restriction
2.L & B 5.Other 8.			16.Regular Lot				%		7.Vacancy
3.Building 6.C/I Land 9.			17.Secondary Lot				%		8.Semi-improved
Financing			18.Hydro Facility				%		9.Fract Share
1.Convent 4.Seller 7.			19.Improvements				%		Acres
2.FHA/VA 5.Private 8.			20.Miscellaneous				%		30.Rear Land 3
3.Assumed 6.Cash 9.Unknown							%		31.Rear Land 4
Validity			Fract. Acre	Acres/Sites					32.Pasture
1.Valid 4.Split 7.Renovate			21.Homesite (Fract)	37	48.00	100	%	0	33.Crop
2.Related 5.Partial 8.Other			22.Baselot (Fract)	38	93.00	100	%	0	34.Hortical I
3.Distress 6.Exempt 9.			23.Misc (Fract)				%		35.Hortical II
Verified			Acres				%		36.Orchard
1.Buyer 4.Agent 7.Family			24.Homesite				%		37.Softwood
2.Seller 5.Pub Rec 8.Other			25.Baselot				%		38.Mixed Wood
3.Lender 6.MLS 9.			26.Frontage 1				%		39.Hardwood
			27.Frontage 2				%		40.Wasteland
			28.Rear Land 1				%		41.Gravel Pit
			29.Rear Land 2				%		42.Mobile Home Si
			Total Acreage		141.00				43.Condo Site
									44.Lot Improvemen
									45.Mobile Home Ho
									46.Golf Course

Southwest Harbor

Map Lot 020-007

Account 260

Location SEAWALL RD/NO ACCESS

Card 1 Of 1 10/28/2020

Building Style	SF Bsmt Living	Layout
1.Conv. 5.Colonial 9.Other	Fin Bsmt Grade	1.Typical 4. 7.
2.Ranch 6.Split 10.	OPEN 5 OPTIONAL	2.Inadeq 5. 8.
3.R Ranch 7.Contemp 11.	Heat Type 100%	3. 6. 9.
4.Cape 8.Cottage 12.	1.HWBB 5.FWA 9.No Heat	Attic
Dwelling Units	2.HWCI 6.GravWA 10.	1.1/4 Fin 4.Full Fin 7.
Other Units	3.H Pump 7.Electric 11.	2.1/2 Fin 5.F/Stair 8.
Stories	4.Radiant 8.F/Wall 12.	3.3/4 Fin 6. 9.None
1.1 4.1.5 7.3.5	Cool Type 0%	Insulation
2.2 5.1.75 8.4	1.Refrig 4.W&C Air 7.	1.Full 4.Minimal 7.
3.3 6.2.5 9.	2.Evapor 5. 8.	2.Heavy 5. 8.
Exterior Walls	3.H Pump 6. 9.None	3.Capped 6. 9.None
1.Wood 5.Shingle 9.Other	Kitchen Style	Unfinished %
2.Vinyl 6.Brick/St 10.Alum	1.Modern 4.Obsolete 7.	Grade & Factor
3.Compos. 7.Single 11.Log	2.Typical 5. 8.	1.E Grade 4.B Grade 7.3A Grade
4.Asbestos 8.Concrete 12.Stone	3.Old Type 6. 9.None	2.D Grade 5.A Grade 8.M&S Grad
Roof Surface	Bath(s) Style	3.C Grade 6.AA Grade 9.Same
1.Asphalt 4.Composit 7.Rolled R	1.Modern 4.Obsolete 7.	SQFT (Footprint)
2.Slate 5.Wood 8.	2.Typical 5. 8.	Condition
3.Metal 6.Other 9.	3.Old Type 6. 9.None	1.Poor 4.Avg 7.V G
SF Masonry Trim	# Rooms	2.Fair 5.Avg+ 8.Exc
OPEN-3-CUSTOM	# Bedrooms	3.Avg- 6.Good 9.Same
OPEN-4-CUSTOM	# Full Baths	Phys. % Good
Year Built	# Half Baths	Funct. % Good
Year Remodeled	# Addn Fixtures	Functional Code
Foundation	# Fireplaces	1.Incomp 4.Plb/Ht 7.
1.Concrete 4.Wood 7.		2.O-Built 5. 8.FractShr
2.C Block 5.Slab 8.		3.Style 6. 9.None
3.Br/Stone 6.Piers 9.		Econ. % Good
Basement		Economic Code
1.1/4 Bmt 4.Full Bmt 7.		0.None 3.No Power 7.
2.1/2 Bmt 5.Crawl 8.		1.Location 9.None 8.
3.3/4 Bmt 6. 9.None		2.Encroach 6. 9.
Bsmt Gar # Cars		Entrance Code 0
Wet Basement		1.Interior 4.Vacant 7.
1.Dry 4.Dirt Flo 7.		2.Refusal 5.Estimate 8.
2.Damp 5. 8.	3.Informed 6. 9.	
3.Wet 6. 9.	Information Code 0	
	1.Owner 4.Agent 7.	
	2.Relative 5.Estimate 8.	
	3.Tenant 6.Other 9.	

Date Inspected

Additions, Outbuildings & Improvements

Type	Year	Units	Grade	Cond	Phys.	Funct.	Sound Value
					%	%	1.One Story Fram
					%	%	2.Two Story Fram
					%	%	3.Three Story Fr
					%	%	4.1 & 1/2 Story
					%	%	5.1 & 3/4 Story
					%	%	6.2 & 1/2 Story
					%	%	21.Open Frame Por
					%	%	22.Encl Frame Por
					%	%	23.Frame Garage
					%	%	24.Frame Shed
					%	%	25.Finished 1/2 S
					%	%	26.1SFr Overhang
					%	%	27.Unfin Basement
					%	%	28.Unfinished Att
					%	%	29.Finished Attic

LACOUNT, STEPHEN H
180 GARDEN GATE LANE
IRVINE, CA 92620

B1421P371

Inspection Witnessed By:

X		Date
No./Date	Description	Date Insp.

Notes:

Southwest Harbor

Property Data			Assessment Record				
Neighborhood 1 Neighborhood 1			Year	Land	Buildings	Exempt	Total
Tree Growth Year 0			2007	13,500	0	0	13,500
X Coordinate 0			2008	13,500	0	0	13,500
Y Coordinate 0			2009	13,500	0	0	13,500
Zone/Land Use 11 Residential 1			2010	11,500	0	0	11,500
Secondary Zone			2011	11,500	0	0	11,500
Topography 2 Rolling 7 Rough			2012	10,100	0	0	10,100
1.Level 4.Below St 7.Rough			2013	10,100	0	0	10,100
2.Rolling 5.Low 8.			2014	10,100	0	0	10,100
3.Above St 6.Swampy 9.			2015	10,100	0	0	10,100
Utilities 9 None			2016	10,100	0	0	10,100
1.Summer Wtr 4.Dr Well 7.Septic			2017	10,100	0	0	10,100
2.Water 5.Dug Well 8.Spring			2018	10,100	0	0	10,100
3.Sewer 6.Lake Wtr 9.None			2019	10,100	0	0	10,100
Street 9 None			2020	10,100	0	0	10,100
1.Paved 4.Proposed 7.			Land Data				
2.Semi Imp 5. 8.							
3.Gravel 6. 9.None			Front Foot				
TG PLAN YEAR 7							
Sale Date			Square Foot				
Price							
Sale Type			Fract. Acre				
1.Land 4.Mobile 7.C/I L&B							
2.L & B 5.Other 8.			Acres				
3.Building 6.C/I Land 9.							
Financing			Acres				
1.Convent 4.Seller 7.							
2.FHA/VA 5.Private 8.			Acres				
3.Assumed 6.Cash 9.Unknown							
Validity			Acres				
1.Valid 4.Split 7.Renovate							
2.Related 5.Partial 8.Other			Acres				
3.Distress 6.Exempt 9.							
Verified			Acres				
1.Buyer 4.Agent 7.Family							
2.Seller 5.Pub Rec 8.Other			Acres				
3.Lender 6.MLS 9.							

Type	Effective		Influence		Influence Codes
	Frontage	Depth	Factor	Code	
11.Regular Lot			%		1.Use
12.Delta Triangle			%		2.R/W
13.Nabla Triangle			%		3.Topography
14.Rear Land			%		4.Size/Shape
15.Miscellaneous			%		5.Access
			%		6.Restriction
			%		7.Vacancy
			%		8.Semi-improved
			%		9.Fract Share
			%		Acres
			%		30.Rear Land 3
			%		31.Rear Land 4
			%		32.Pasture
			%		33.Crop
			%		34.Hortical I
			%		35.Hortical II
			%		36.Orchard
			%		37.Softwood
			%		38.Mixed Wood
			%		39.Hardwood
			%		40.Wasteland
			%		41.Gravel Pit
			%		42.Mobile Home Si
			%		43.Condo Site
			%		44.Lot Improvemen
			%		45.Mobile Home Ho
			%		46.Golf Course
Total Acreage		18.00			

Southwest Harbor

Map Lot 020-010

Account 778

Location SEAWALL RD/NO ACCESS

Card 1 Of 1 10/28/2020

Building Style	SF Bsmt Living	Layout
1.Conv. 5.Colonial 9.Other	Fin Bsmt Grade	1.Typical 4. 7.
2.Ranch 6.Split 10.	OPEN 5 OPTIONAL	2.Inadeq 5. 8.
3.R Ranch 7.Contemp 11.	Heat Type 100%	3. 6. 9.
4.Cape 8.Cottage 12.	1.HWBB 5.FWA 9.No Heat	Attic
Dwelling Units	2.HWCI 6.GravWA 10.	1.1/4 Fin 4.Full Fin 7.
Other Units	3.H Pump 7.Electric 11.	2.1/2 Fin 5.F/Stair 8.
Stories	4.Radiant 8.F/Wall 12.	3.3/4 Fin 6. 9.None
1.1 4.1.5 7.3.5	Cool Type 0%	Insulation
2.2 5.1.75 8.4	1.Refrig 4.W&C Air 7.	1.Full 4.Minimal 7.
3.3 6.2.5 9.	2.Evapor 5. 8.	2.Heavy 5. 8.
Exterior Walls	3.H Pump 6. 9.None	3.Capped 6. 9.None
1.Wood 5.Shingle 9.Other	Kitchen Style	Unfinished %
2.Vinyl 6.Brick/St 10.Alum	1.Modern 4.Obsolete 7.	Grade & Factor
3.Compos. 7.Single 11.Log	2.Typical 5. 8.	1.E Grade 4.B Grade 7.3A Grade
4.Asbestos 8.Concrete 12.Stone	3.Old Type 6. 9.None	2.D Grade 5.A Grade 8.M&S Grad
Roof Surface	Bath(s) Style	3.C Grade 6.AA Grade 9.Same
1.Asphalt 4.Composit 7.Rolled R	1.Modern 4.Obsolete 7.	SQFT (Footprint)
2.Slate 5.Wood 8.	2.Typical 5. 8.	Condition
3.Metal 6.Other 9.	3.Old Type 6. 9.None	1.Poor 4.Avg 7.V G
SF Masonry Trim	# Rooms	2.Fair 5.Avg+ 8.Exc
OPEN-3-CUSTOM	# Bedrooms	3.Avg- 6.Good 9.Same
OPEN-4-CUSTOM	# Full Baths	Phys. % Good
Year Built	# Half Baths	Funct. % Good
Year Remodeled	# Addn Fixtures	Functional Code
Foundation	# Fireplaces	1.Incomp 4.Plb/Ht 7.
1.Concrete 4.Wood 7.		2.O-Built 5. 8.FractShr
2.C Block 5.Slab 8.		3.Style 6. 9.None
3.Br/Stone 6.Piers 9.		Econ. % Good
Basement		Economic Code
1.1/4 Bmt 4.Full Bmt 7.		0.None 3.No Power 7.
2.1/2 Bmt 5.Crawl 8.		1.Location 9.None 8.
3.3/4 Bmt 6. 9.None		2.Encroach 6. 9.
Bsmt Gar # Cars		Entrance Code 0
Wet Basement		1.Interior 4.Vacant 7.
1.Dry 4.Dirt Flo 7.		2.Refusal 5.Estimate 8.
2.Damp 5. 8.	3.Informed 6. 9.	
3.Wet 6. 9.	Information Code 0	
	1.Owner 4.Agent 7.	
	2.Relative 5.Estimate 8.	
	3.Tenant 6.Other 9.	

Date Inspected

Additions, Outbuildings & Improvements

Type	Year	Units	Grade	Cond	Phys.	Funct.	Sound Value
					%	%	1.One Story Fram
					%	%	2.Two Story Fram
					%	%	3.Three Story Fr
					%	%	4.1 & 1/2 Story
					%	%	5.1 & 3/4 Story
					%	%	6.2 & 1/2 Story
					%	%	21.Open Frame Por
					%	%	22.Encl Frame Por
					%	%	23.Frame Garage
					%	%	24.Frame Shed
					%	%	25.Finished 1/2 S
					%	%	26.1SFr Overhang
					%	%	27.Unfin Basement
					%	%	28.Unfinished Att
					%	%	29.Finished Attic

Southwest Harbor

Map Lot 020-015

Account 647

Location SEAWALL RD/NO ACCESS

Card 1 Of 1 10/28/2020

Building Style	SF Bsmt Living	Layout
1.Conv. 5.Colonial 9.Other	Fin Bsmt Grade	1.Typical 4. 7.
2.Ranch 6.Split 10.	OPEN 5 OPTIONAL	2.Inadeq 5. 8.
3.R Ranch 7.Contemp 11.	Heat Type 100%	3. 6. 9.
4.Cape 8.Cottage 12.	1.HWBB 5.FWA 9.No Heat	Attic
Dwelling Units	2.HWCI 6.GravWA 10.	1.1/4 Fin 4.Full Fin 7.
Other Units	3.H Pump 7.Electric 11.	2.1/2 Fin 5.F/Stair 8.
Stories	4.Radiant 8.F/Wall 12.	3.3/4 Fin 6. 9.None
1.1 4.1.5 7.3.5	Cool Type 0%	Insulation
2.2 5.1.75 8.4	1.Refrig 4.W&C Air 7.	1.Full 4.Minimal 7.
3.3 6.2.5 9.	2.Evapor 5. 8.	2.Heavy 5. 8.
Exterior Walls	3.H Pump 6. 9.None	3.Capped 6. 9.None
1.Wood 5.Shingle 9.Other	Kitchen Style	Unfinished %
2.Vinyl 6.Brick/St 10.Alum	1.Modern 4.Obsolete 7.	Grade & Factor
3.Compos. 7.Single 11.Log	2.Typical 5. 8.	1.E Grade 4.B Grade 7.3A Grade
4.Asbestos 8.Concrete 12.Stone	3.Old Type 6. 9.None	2.D Grade 5.A Grade 8.M&S Grad
Roof Surface	Bath(s) Style	3.C Grade 6.AA Grade 9.Same
1.Asphalt 4.Composit 7.Rolled R	1.Modern 4.Obsolete 7.	SQFT (Footprint)
2.Slate 5.Wood 8.	2.Typical 5. 8.	Condition
3.Metal 6.Other 9.	3.Old Type 6. 9.None	1.Poor 4.Avg 7.V G
SF Masonry Trim	# Rooms	2.Fair 5.Avg+ 8.Exc
OPEN-3-CUSTOM	# Bedrooms	3.Avg- 6.Good 9.Same
OPEN-4-CUSTOM	# Full Baths	Phys. % Good
Year Built	# Half Baths	Funct. % Good
Year Remodeled	# Addn Fixtures	Functional Code
Foundation	# Fireplaces	1.Incomp 4.Plb/Ht 7.
1.Concrete 4.Wood 7.		2.O-Built 5. 8.FractShr
2.C Block 5.Slab 8.		3.Style 6. 9.None
3.Br/Stone 6.Piers 9.		Econ. % Good
Basement		Economic Code
1.1/4 Bmt 4.Full Bmt 7.		0.None 3.No Power 7.
2.1/2 Bmt 5.Crawl 8.		1.Location 9.None 8.
3.3/4 Bmt 6. 9.None		2.Encroach 6. 9.
Bsmt Gar # Cars		Entrance Code 0
Wet Basement		1.Interior 4.Vacant 7.
1.Dry 4.Dirt Flo 7.		2.Refusal 5.Estimate 8.
2.Damp 5. 8.	3.Informed 6. 9.	
3.Wet 6. 9.	Information Code 0	
	1.Owner 4.Agent 7.	
	2.Relative 5.Estimate 8.	
	3.Tenant 6.Other 9.	

Date Inspected

Additions, Outbuildings & Improvements

Type	Year	Units	Grade	Cond	Phys.	Funct.	Sound Value
					%	%	1.One Story Fram
					%	%	2.Two Story Fram
					%	%	3.Three Story Fr
					%	%	4.1 & 1/2 Story
					%	%	5.1 & 3/4 Story
					%	%	6.2 & 1/2 Story
					%	%	21.Open Frame Por
					%	%	22.Encl Frame Por
					%	%	23.Frame Garage
					%	%	24.Frame Shed
					%	%	25.Finished 1/2 S
					%	%	26.1SFr Overhang
					%	%	27.Unfin Basement
					%	%	28.Unfinished Att
					%	%	29.Finished Attic

HOOK, CAROLYN T
406 PARADISE ROAD - 2B
SWAMPSCOTT MA 01907 1311

B1188P524

Inspection Witnessed By:

No./Date	Description	Date Insp.
X		

Notes:

Southwest Harbor

Property Data			Assessment Record				
Neighborhood 1 Neighborhood 1			Year	Land	Buildings	Exempt	Total
Tree Growth Year 0			2007	11,300	0	0	11,300
X Coordinate 0			2008	11,300	0	0	11,300
Y Coordinate 0			2009	11,300	0	0	11,300
Zone/Land Use 11 Residential 1			2010	9,600	0	0	9,600
Secondary Zone			2011	9,600	0	0	9,600
Topography 2 Rolling 7 Rough			2012	8,500	0	0	8,500
1.Level 4.Below St 7.Rough			2013	8,500	0	0	8,500
2.Rolling 5.Low 8.			2014	8,500	0	0	8,500
3.Above St 6.Swampy 9.			2015	8,500	0	0	8,500
Utilities 9 None			2016	8,500	0	0	8,500
1.Summer Wtr 4.Dr Well 7.Septic			2017	8,500	0	0	8,500
2.Water 5.Dug Well 8.Spring			2018	8,500	0	0	8,500
3.Sewer 6.Lake Wtr 9.None			2019	8,500	0	0	8,500
Street 9 None			2020	8,500	0	0	8,500
1.Paved 4.Proposed 7.			Land Data				
2.Semi Imp 5. 8.							
3.Gravel 6. 9.None			Front Foot				
TG PLAN YEAR 7							
Sale Date			Square Foot				
Price							
Sale Type			Fract. Acre				
1.Land 4.Mobile 7.C/I L&B							
2.L & B 5.Other 8.			Acres				
3.Building 6.C/I Land 9.							
Financing			Acres				
1.Convent 4.Seller 7.							
2.FHA/VA 5.Private 8.			Acres				
3.Assumed 6.Cash 9.Unknown							
Validity			Acres				
1.Valid 4.Split 7.Renovate							
2.Related 5.Partial 8.Other			Acres				
3.Distress 6.Exempt 9.							
Verified			Acres				
1.Buyer 4.Agent 7.Family							
2.Seller 5.Pub Rec 8.Other			Acres				
3.Lender 6.MLS 9.							

Type	Effective		Influence		Influence Codes
	Frontage	Depth	Factor	Code	
11.Regular Lot			%		1.Use
12.Delta Triangle			%		2.R/W
13.Nabla Triangle			%		3.Topography
14.Rear Land			%		4.Size/Shape
15.Miscellaneous			%		5.Access
			%		6.Restriction
			%		7.Vacancy
			%		8.Semi-improved
			%		9.Fract Share
			%		Acres
			%		30.Rear Land 3
			%		31.Rear Land 4
			%		32.Pasture
			%		33.Crop
			%		34.Horticult I
			%		35.Horticult II
			%		36.Orchard
			%		37.Softwood
			%		38.Mixed Wood
			%		39.Hardwood
			%		40.Wasteland
			%		41.Gravel Pit
			%		42.Mobile Home Si
			%		43.Condo Site
			%		44.Lot Improvemen
			%		45.Mobile Home Ho
			%		46.Golf Course
Total Acreage			7.56		

Southwest Harbor

Map Lot 020-017

Account 646

Location SEAWALL RD/NO ACCESS

Card 1 Of 1 10/28/2020

Building Style	SF Bsmt Living	Layout
1.Conv. 5.Colonial 9.Other	Fin Bsmt Grade	1.Typical 4. 7.
2.Ranch 6.Split 10.	OPEN 5 OPTIONAL	2.Inadeq 5. 8.
3.R Ranch 7.Contemp 11.	Heat Type 100%	3. 6. 9.
4.Cape 8.Cottage 12.	1.HWBB 5.FWA 9.No Heat	Attic
Dwelling Units	2.HWCI 6.GravWA 10.	1.1/4 Fin 4.Full Fin 7.
Other Units	3.H Pump 7.Electric 11.	2.1/2 Fin 5.F/Stair 8.
Stories	4.Radiant 8.F/Wall 12.	3.3/4 Fin 6. 9.None
1.1 4.1.5 7.3.5	Cool Type 0%	Insulation
2.2 5.1.75 8.4	1.Refrig 4.W&C Air 7.	1.Full 4.Minimal 7.
3.3 6.2.5 9.	2.Evapor 5. 8.	2.Heavy 5. 8.
Exterior Walls	3.H Pump 6. 9.None	3.Capped 6. 9.None
1.Wood 5.Shingle 9.Other	Kitchen Style	Unfinished %
2.Vinyl 6.Brick/St 10.Alum	1.Modern 4.Obsolete 7.	Grade & Factor
3.Compos. 7.Single 11.Log	2.Typical 5. 8.	1.E Grade 4.B Grade 7.3A Grade
4.Asbestos 8.Concrete 12.Stone	3.Old Type 6. 9.None	2.D Grade 5.A Grade 8.M&S Grad
Roof Surface	Bath(s) Style	3.C Grade 6.AA Grade 9.Same
1.Asphalt 4.Composit 7.Rolled R	1.Modern 4.Obsolete 7.	SQFT (Footprint)
2.Slate 5.Wood 8.	2.Typical 5. 8.	Condition
3.Metal 6.Other 9.	3.Old Type 6. 9.None	1.Poor 4.Avg 7.V G
SF Masonry Trim	# Rooms	2.Fair 5.Avg+ 8.Exc
OPEN-3-CUSTOM	# Bedrooms	3.Avg- 6.Good 9.Same
OPEN-4-CUSTOM	# Full Baths	Phys. % Good
Year Built	# Half Baths	Funct. % Good
Year Remodeled	# Addn Fixtures	Functional Code
Foundation	# Fireplaces	1.Incomp 4.Plb/Ht 7.
1.Concrete 4.Wood 7.		2.O-Built 5. 8.FractShr
2.C Block 5.Slab 8.		3.Style 6. 9.None
3.Br/Stone 6.Piers 9.		Econ. % Good
Basement		Economic Code
1.1/4 Bmt 4.Full Bmt 7.		0.None 3.No Power 7.
2.1/2 Bmt 5.Crawl 8.		1.Location 9.None 8.
3.3/4 Bmt 6. 9.None		2.Encroach 6. 9.
Bsmt Gar # Cars		Entrance Code 0
Wet Basement		1.Interior 4.Vacant 7.
1.Dry 4.Dirt Flo 7.		2.Refusal 5.Estimate 8.
2.Damp 5. 8.	3.Informed 6. 9.	
3.Wet 6. 9.	Information Code 0	
	1.Owner 4.Agent 7.	
	2.Relative 5.Estimate 8.	
	3.Tenant 6.Other 9.	

Date Inspected

Additions, Outbuildings & Improvements

Type	Year	Units	Grade	Cond	Phys.	Funct.	Sound Value
					%	%	1.One Story Fram
					%	%	2.Two Story Fram
					%	%	3.Three Story Fr
					%	%	4.1 & 1/2 Story
					%	%	5.1 & 3/4 Story
					%	%	6.2 & 1/2 Story
					%	%	21.Open Frame Por
					%	%	22.Encl Frame Por
					%	%	23.Frame Garage
					%	%	24.Frame Shed
					%	%	25.Finished 1/2 S
					%	%	26.1SFr Overhang
					%	%	27.Unfin Basement
					%	%	28.Unfinished Att
					%	%	29.Finished Attic

HOOK, CAROLYN T
406 PARADISE ROAD - 2B
SWAMPSCOTT MA 01907 1311

B1042P179

Inspection Witnessed By:

No./Date	Description	Date Insp.
X		

Notes:

Southwest Harbor

Property Data			Assessment Record				
Neighborhood 1 Neighborhood 1			Year	Land	Buildings	Exempt	Total
Tree Growth Year 0			2007	29,600	0	0	29,600
X Coordinate 0			2008	29,600	0	0	29,600
Y Coordinate 0			2009	29,600	0	0	29,600
Zone/Land Use 11 Residential 1			2010	25,100	0	0	25,100
Secondary Zone			2011	25,100	0	0	25,100
Topography 2 Rolling 7 Rough			2012	22,200	0	0	22,200
1.Level 4.Below St 7.Rough			2013	22,200	0	0	22,200
2.Rolling 5.Low 8.			2014	22,200	0	0	22,200
3.Above St 6.Swampy 9.			2015	22,200	0	0	22,200
Utilities 9 None			2016	22,200	0	0	22,200
1.Summer Wtr 4.Dr Well 7.Septic			2017	22,200	0	0	22,200
2.Water 5.Dug Well 8.Spring			2018	22,200	0	0	22,200
3.Sewer 6.Lake Wtr 9.None			2019	22,200	0	0	22,200
Street 9 None			2020	22,200	0	0	22,200
1.Paved 4.Proposed 7.			Land Data				
2.Semi Imp 5. 8.							
3.Gravel 6. 9.None			Front Foot				
TG PLAN YEAR 7							
Sale Date			Square Foot				
Price							
Sale Type			Fract. Acre				
1.Land 4.Mobile 7.C/I L&B							
2.L & B 5.Other 8.			Acres				
3.Building 6.C/I Land 9.							
Financing			Acres				
1.Convent 4.Seller 7.							
2.FHA/VA 5.Private 8.			Acres				
3.Assumed 6.Cash 9.Unknown							
Validity			Acres				
1.Valid 4.Split 7.Renovate							
2.Related 5.Partial 8.Other			Acres				
3.Distress 6.Exempt 9.							
Verified			Acres				
1.Buyer 4.Agent 7.Family							
2.Seller 5.Pub Rec 8.Other			Acres				
3.Lender 6.MLS 9.							

Type	Effective		Influence		Influence Codes
	Frontage	Depth	Factor	Code	
11.Regular Lot			%		1.Use
12.Delta Triangle			%		2.R/W
13.Nabla Triangle			%		3.Topography
14.Rear Land			%		4.Size/Shape
15.Miscellaneous			%		5.Access
			%		6.Restriction
			%		7.Vacancy
			%		8.Semi-improved
			%		9.Fract Share
			%		Acres
			%		30.Rear Land 3
			%		31.Rear Land 4
			%		32.Pasture
			%		33.Crop
			%		34.Hortical I
			%		35.Hortical II
			%		36.Orchard
			%		37.Softwood
			%		38.Mixed Wood
			%		39.Hardwood
			%		40.Wasteland
			%		41.Gravel Pit
			%		42.Mobile Home Si
			%		43.Condo Site
			%		44.Lot Improvemen
			%		45.Mobile Home Ho
			%		46.Golf Course
Total Acreage			19.70		

Southwest Harbor

Map Lot 020-018

Account 649

Location SEAWALL RD/NO ACCESS

Card 1 Of 1 10/28/2020

Building Style	SF Bsmt Living	Layout
1.Conv. 5.Colonial 9.Other	Fin Bsmt Grade	1.Typical 4. 7.
2.Ranch 6.Split 10.	OPEN 5 OPTIONAL	2.Inadeq 5. 8.
3.R Ranch 7.Contemp 11.	Heat Type 100%	3. 6. 9.
4.Cape 8.Cottage 12.	1.HWBB 5.FWA 9.No Heat	Attic
Dwelling Units	2.HWCI 6.GravWA 10.	1.1/4 Fin 4.Full Fin 7.
Other Units	3.H Pump 7.Electric 11.	2.1/2 Fin 5.F/Stair 8.
Stories	4.Radiant 8.F/Wall 12.	3.3/4 Fin 6. 9.None
1.1 4.1.5 7.3.5	Cool Type 0%	Insulation
2.2 5.1.75 8.4	1.Refrig 4.W&C Air 7.	1.Full 4.Minimal 7.
3.3 6.2.5 9.	2.Evapor 5. 8.	2.Heavy 5. 8.
Exterior Walls	3.H Pump 6. 9.None	3.Capped 6. 9.None
1.Wood 5.Shingle 9.Other	Kitchen Style	Unfinished %
2.Vinyl 6.Brick/St 10.Alum	1.Modern 4.Obsolete 7.	Grade & Factor
3.Compos. 7.Single 11.Log	2.Typical 5. 8.	1.E Grade 4.B Grade 7.3A Grade
4.Asbestos 8.Concrete 12.Stone	3.Old Type 6. 9.None	2.D Grade 5.A Grade 8.M&S Grad
Roof Surface	Bath(s) Style	3.C Grade 6.AA Grade 9.Same
1.Asphalt 4.Composit 7.Rolled R	1.Modern 4.Obsolete 7.	SQFT (Footprint)
2.Slate 5.Wood 8.	2.Typical 5. 8.	Condition
3.Metal 6.Other 9.	3.Old Type 6. 9.None	1.Poor 4.Avg 7.V G
SF Masonry Trim	# Rooms	2.Fair 5.Avg+ 8.Exc
OPEN-3-CUSTOM	# Bedrooms	3.Avg- 6.Good 9.Same
OPEN-4-CUSTOM	# Full Baths	Phys. % Good
Year Built	# Half Baths	Funct. % Good
Year Remodeled	# Addn Fixtures	Functional Code
Foundation	# Fireplaces	1.Incomp 4.Plb/Ht 7.
1.Concrete 4.Wood 7.		2.O-Built 5. 8.FractShr
2.C Block 5.Slab 8.		3.Style 6. 9.None
3.Br/Stone 6.Piers 9.		Econ. % Good
Basement		Economic Code
1.1/4 Bmt 4.Full Bmt 7.		0.None 3.No Power 7.
2.1/2 Bmt 5.Crawl 8.		1.Location 9.None 8.
3.3/4 Bmt 6. 9.None		2.Encroach 6. 9.
Bsmt Gar # Cars		Entrance Code 0
Wet Basement		1.Interior 4.Vacant 7.
1.Dry 4.Dirt Flo 7.		2.Refusal 5.Estimate 8.
2.Damp 5. 8.	3.Informed 6. 9.	
3.Wet 6. 9.	Information Code 0	
	1.Owner 4.Agent 7.	
	2.Relative 5.Estimate 8.	
	3.Tenant 6.Other 9.	

Date Inspected

Additions, Outbuildings & Improvements

Type	Year	Units	Grade	Cond	Phys.	Funct.	Sound Value
					%	%	1.One Story Fram
					%	%	2.Two Story Fram
					%	%	3.Three Story Fr
					%	%	4.1 & 1/2 Story
					%	%	5.1 & 3/4 Story
					%	%	6.2 & 1/2 Story
					%	%	21.Open Frame Por
					%	%	22.Encl Frame Por
					%	%	23.Frame Garage
					%	%	24.Frame Shed
					%	%	25.Finished 1/2 S
					%	%	26.1SFr Overhang
					%	%	27.Unfin Basement
					%	%	28.Unfinished Att
					%	%	29.Finished Attic

UNITED STATES OF AMERICA
1849 C STREET N.W.
ROOM 2444
WASHINGTON DC 00240

B2827P553

Inspection Witnessed By:

X Date

No./Date	Description	Date Insp.

Notes:

Southwest Harbor

Property Data		
Neighborhood	1 Neighborhood 1	
Tree Growth Year	0	
X Coordinate	0	
Y Coordinate	0	
Zone/Land Use	11 Residential 1	
Secondary Zone		
Topography	2 Rolling	7 Rough
1.Level	4.Below St	7.Rough
2.Rolling	5.Low	8.
3.Above St	6.Swampy	9.
Utilities	9 None	
1.Summer Wtr	4.Dr Well	7.Septic
2.Water	5.Dug Well	8.Spring
3.Sewer	6.Lake Wtr	9.None
Street	9 None	
1.Paved	4.Proposed	7.
2.Semi Imp	5.	8.
3.Gravel	6.	9.None
TG PLAN YEAR	5	
	0	
Sale Data		
Sale Date	4/01/1998	
Price	49,900	
Sale Type	1 Land Only	
1.Land	4.Mobile	7.C/I L&B
2.L & B	5.Other	8.
3.Building	6.C/I Land	9.
Financing	9 Unknown	
1.Convent	4.Seller	7.
2.FHA/VA	5.Private	8.
3.Assumed	6.Cash	9.Unknown
Validity	8 Other Non Valid	
1.Valid	4.Split	7.Renovate
2.Related	5.Partial	8.Other
3.Distress	6.Exempt	9.
Verified	5 Public Record	
1.Buyer	4.Agent	7.Family
2.Seller	5.Pub Rec	8.Other
3.Lender	6.MLS	9.

Assessment Record				
Year	Land	Buildings	Exempt	Total
2007	204,000	0	204,000	0
2008	204,000	0	204,000	0
2009	204,000	0	204,000	0
2010	173,400	0	173,400	0
2011	173,400	0	173,400	0
2012	153,000	0	153,000	0
2013	153,000	0	153,000	0
2014	153,000	0	153,000	0
2015	153,000	0	153,000	0
2016	153,000	0	153,000	0
2017	153,000	0	153,000	0
2018	153,000	0	153,000	0
2019	153,000	0	153,000	0
2020	153,000	0	153,000	0

Land Data						
Front Foot	Type	Effective		Influence		Influence Codes
		Frontage	Depth	Factor	Code	
11.Regular Lot				%		1.Use
12.Delta Triangle				%		2.R/W
13.Nabla Triangle				%		3.Topography
14.Rear Land				%		4.Size/Shape
15.Miscellaneous				%		5.Access
				%		6.Restriction
				%		7.Vacancy
				%		8.Semi-improved
				%		9.Fract Share
Square Foot		Square Feet				Acres
16.Regular Lot				%		30.Rear Land 3
17.Secondary Lot				%		31.Rear Land 4
18.Hydro Facility				%		32.Pasture
19.Improvements				%		33.Crop
20.Miscellaneous				%		34.Hortical I
				%		35.Hortical II
				%		36.Orchard
				%		37.Softwood
				%		38.Mixed Wood
				%		39.Hardwood
				%		40.Wasteland
				%		41.Gravel Pit
				%		42.Mobile Home Si
				%		43.Condo Site
				%		44.Lot Improvemen
				%		45.Mobile Home Ho
				%		46.Golf Course
Total Acreage				53.45		

Southwest Harbor

Map Lot 020-019

Account 1144

Location 50 PORK CHOP LANE

Card 1 Of 1 10/28/2020

Building Style	SF Bsmt Living	Layout
1.Conv. 5.Colonial 9.Other	Fin Bsmt Grade	1.Typical 4. 7.
2.Ranch 6.Split 10.	OPEN 5 OPTIONAL	2.Inadeq 5. 8.
3.R Ranch 7.Contemp 11.	Heat Type 100%	3. 6. 9.
4.Cape 8.Cottage 12.	1.HWBB 5.FWA 9.No Heat	Attic
Dwelling Units	2.HWCI 6.GravWA 10.	1.1/4 Fin 4.Full Fin 7.
Other Units	3.H Pump 7.Electric 11.	2.1/2 Fin 5.F/Stair 8.
Stories	4.Radiant 8.F/Wall 12.	3.3/4 Fin 6. 9.None
1.1 4.1.5 7.3.5	Cool Type 0%	Insulation
2.2 5.1.75 8.4	1.Refrig 4.W&C Air 7.	1.Full 4.Minimal 7.
3.3 6.2.5 9.	2.Evapor 5. 8.	2.Heavy 5. 8.
Exterior Walls	3.H Pump 6. 9.None	3.Capped 6. 9.None
1.Wood 5.Shingle 9.Other	Kitchen Style	Unfinished %
2.Vinyl 6.Brick/St 10.Alum	1.Modern 4.Obsolete 7.	Grade & Factor
3.Compos. 7.Single 11.Log	2.Typical 5. 8.	1.E Grade 4.B Grade 7.3A Grade
4.Asbestos 8.Concrete 12.Stone	3.Old Type 6. 9.None	2.D Grade 5.A Grade 8.M&S Grad
Roof Surface	Bath(s) Style	3.C Grade 6.AA Grade 9.Same
1.Asphalt 4.Composit 7.Rolled R	1.Modern 4.Obsolete 7.	SQFT (Footprint)
2.Slate 5.Wood 8.	2.Typical 5. 8.	Condition
3.Metal 6.Other 9.	3.Old Type 6. 9.None	1.Poor 4.Avg 7.V G
SF Masonry Trim	# Rooms	2.Fair 5.Avg+ 8.Exc
OPEN-3-CUSTOM	# Bedrooms	3.Avg- 6.Good 9.Same
OPEN-4-CUSTOM	# Full Baths	Phys. % Good
Year Built	# Half Baths	Funct. % Good
Year Remodeled	# Addn Fixtures	Functional Code
Foundation	# Fireplaces	1.Incomp 4.Plb/Ht 7.
1.Concrete 4.Wood 7.		2.O-Built 5. 8.FractShr
2.C Block 5.Slab 8.		3.Style 6. 9.None
3.Br/Stone 6.Piers 9.		Econ. % Good
Basement		Economic Code
1.1/4 Bmt 4.Full Bmt 7.		0.None 3.No Power 7.
2.1/2 Bmt 5.Crawl 8.		1.Location 9.None 8.
3.3/4 Bmt 6. 9.None		2.Encroach 6. 9.
Bsmt Gar # Cars		Entrance Code 0
Wet Basement		1.Interior 4.Vacant 7.
1.Dry 4.Dirt Flo 7.		2.Refusal 5.Estimate 8.
2.Damp 5. 8.	3.Informed 6. 9.	
3.Wet 6. 9.	Information Code 0	
	1.Owner 4.Agent 7.	
	2.Relative 5.Estimate 8.	
	3.Tenant 6.Other 9.	

Date Inspected

Additions, Outbuildings & Improvements

Type	Year	Units	Grade	Cond	Phys.	Funct.	Sound Value
					%	%	1.One Story Fram
					%	%	2.Two Story Fram
					%	%	3.Three Story Fr
					%	%	4.1 & 1/2 Story
					%	%	5.1 & 3/4 Story
					%	%	6.2 & 1/2 Story
					%	%	21.Open Frame Por
					%	%	22.Encl Frame Por
					%	%	23.Frame Garage
					%	%	24.Frame Shed
					%	%	25.Finished 1/2 S
					%	%	26.1SFr Overhang
					%	%	27.Unfin Basement
					%	%	28.Unfinished Att
					%	%	29.Finished Attic

BARNES, PHOEBE
P.O. BOX 676
SOUTHWEST HARBOR ME 04679

B1255P673 B5719P164

Previous Owner
RICH, JACK
7629 NORTHERN OAK ST.

WEST MELBOURNE FL 32904
Sale Date: 11/18/2011

Inspection Witnessed By:

X	Date
No./Date	Description

Notes:
4/1/14 NAH EST ALL COMP
14 ADD PARK RESTRICTIONS TO LOT LIKE 20-3
5/29/13 VAC HSE AND SHED REPLACED, LIST NEW AND LIST SHED AS 1sFr
1/2/09- REV. NAH N/C.

Southwest Harbor

Property Data			Assessment Record						
Neighborhood	1 Neighborhood 1		Year	Land	Buildings	Exempt	Total		
Tree Growth Year	0		2007	127,400	65,800	0	193,200		
X Coordinate	0		2008	127,400	65,800	0	193,200		
Y Coordinate	0		2009	127,400	65,800	0	193,200		
Zone/Land Use	11 Residential 1		2010	108,300	56,100	0	164,400		
Secondary Zone			2011	108,300	56,100	0	164,400		
			2012	95,600	49,600	0	145,200		
Topography	2 Rolling		2013	95,600	49,600	0	145,200		
1.Level	4.Below St	7.Rough	2014	75,700	99,500	0	175,200		
2.Rolling	5.Low	8.	2015	75,700	99,500	0	175,200		
3.Above St	6.Swampy	9.	2016	75,700	99,500	0	175,200		
Utilities	4 Drilled Well 7 Septic		2017	75,700	99,500	0	175,200		
1.Summer Wtr	4.Dr Well	7.Septic	2018	75,700	99,500	0	175,200		
2.Water	5.Dug Well	8.Spring	2019	75,700	99,500	0	175,200		
3.Sewer	6.Lake Wtr	9.None	2020	75,700	99,500	0	175,200		
Street	1 Paved								
1.Paved	4.Proposed	7.							
2.Semi Imp	5.	8.							
3.Gravel	6.	9.None							
TG PLAN YEAR	0								
	0								
Sale Data									
Sale Date	11/18/2011								
Price	120,000								
Sale Type	2 Land & Buildings								
1.Land	4.Mobile	7.C/I L&B							
2.L & B	5.Other	8.							
3.Building	6.C/I Land	9.							
Financing	5 Private Finance								
1.Convent	4.Seller	7.							
2.FHA/VA	5.Private	8.							
3.Assumed	6.Cash	9.Unknown							
Validity	1 Arms Length Sale								
1.Valid	4.Split	7.Renovate							
2.Related	5.Partial	8.Other							
3.Distress	6.Exempt	9.							
Verified	5 Public Record								
1.Buyer	4.Agent	7.Family							
2.Seller	5.Pub Rec	8.Other							
3.Lender	6.MLS	9.							
			Land Data						
			Front Foot	Type	Effective		Influence		Influence Codes
					Frontage	Depth	Factor	Code	
			11.Regular Lot				%		1.Use
			12.Delta Triangle				%		2.R/W
			13.Nabla Triangle				%		3.Topography
			14.Rear Land				%		4.Size/Shape
			15.Miscellaneous				%		5.Access
							%		6.Restriction
							%		7.Vacancy
							%		8.Semi-improved
							%		9.Fract Share
							%		Acres
							%		30.Rear Land 3
							%		31.Rear Land 4
							%		32.Pasture
							%		33.Crop
							%		34.Hortical I
							%		35.Hortical II
							%		36.Orchard
							%		37.Softwood
							%		38.Mixed Wood
							%		39.Hardwood
							%		40.Wasteland
							%		41.Gravel Pit
							%		42.Mobile Home Si
							%		43.Condo Site
							%		44.Lot Improvemen
							%		45.Mobile Home Ho
							%		46.Golf Course
					Total Acreage	1.10			

Southwest Harbor

Map Lot 020-020

Account 1145

Location 10 PORK CHOP LANE

Card 1

Of 1

10/28/2020

Building Style 1 Conventional	SF Bsmt Living 0	Layout 1 Typical
1.Conv. 5.Colonial 9.Other	Fin Bsmt Grade 0 0	1.Typical 4. 7.
2.Ranch 6.Split 10.	OPEN 5 OPTIONAL 0	2.Inadeq 5. 8.
3.R Ranch 7.Contemp 11.	Heat Type 100% 8 Floor/Wall Unit	3. 6. 9.
4.Cape 8.Cottage 12.	1.HWBB 5.FWA 9.No Heat	Attic 9 None
Dwelling Units 1	2.HWCI 6.GravWA 10.	1.1/4 Fin 4.Full Fin 7.
Other Units 0	3.H Pump 7.Electric 11.	2.1/2 Fin 5.FI/Stair 8.
Stories 1 One Story	4.Radiant 8.FI/Wall 12.	3.3/4 Fin 6. 9.None
1.1 4.1.5 7.3.5	Cool Type 0% 9 None	Insulation 1 Full
2.2 5.1.75 8.4	1.Refrig 4.W&C Air 7.	1.Full 4.Minimal 7.
3.3 6.2.5 9.	2.Evapor 5. 8.	2.Heavy 5. 8.
Exterior Walls 1 Wood Siding	3.H Pump 6. 9.None	3.Capped 6. 9.None
1.Wood 5.Shingle 9.Other	Kitchen Style 2 Typical	Unfinished % 0%
2.Vinyl 6.Brick/St 10.Alum	1.Modern 4.Obsolete 7.	Grade & Factor 3 C 105%
3.Compos. 7.Single 11.Log	2.Typical 5. 8.	1.E Grade 4.B Grade 7.3A Grade
4.Asbestos 8.Concrete 12.Stone	3.Old Type 6. 9.None	2.D Grade 5.A Grade 8.M&S Grad
Roof Surface 3 Sheet Metal	Bath(s) Style 2 Typical Bath(s)	3.C Grade 6.AA Grade 9.Same
1.Asphalt 4.Composit 7.Rolled R	1.Modern 4.Obsolete 7.	SQFT (Footprint) 504
2.Slate 5.Wood 8.	2.Typical 5. 8.	Condition 4 Average
3.Metal 6.Other 9.	3.Old Type 6. 9.None	1.Poor 4.Avg 7.V G
SF Masonry Trim 0	# Rooms 0	2.Fair 5.Avg+ 8.Exc
OPEN-3-CUSTOM 0	# Bedrooms 0	3.Avg- 6.Good 9.Same
OPEN-4-CUSTOM 0	# Full Baths 1	Phys. % Good 0%
Year Built 2012	# Half Baths 1	Funct. % Good 100%
Year Remodeled 0	# Addn Fixtures 0	Functional Code 9 None
Foundation 1 Concrete	# Fireplaces 0	1.Incomp 4.Plb/Ht 7.
1.Concrete 4.Wood 7.		2.O-Built 5. 8.FractShr
2.C Block 5.Slab 8.		3.Style 6. 9.None
3.Br/Stone 6.Piers 9.		Econ. % Good 100%
Basement 2 1/2 Basement		Economic Code None
1.1/4 Bmt 4.Full Bmt 7.		0.None 3.No Power 7.
2.1/2 Bmt 5.Crawl 8.		1.Location 9.None 8.
3.3/4 Bmt 6. 9.None		2.Encroach 6. 9.
Bsmt Gar # Cars 0		Entrance Code 1 Interior Inspect
Wet Basement 1 Dry Basement		1.Interior 4.Vacant 7.
1.Dry 4.Dirt Flo 7.		2.Refusal 5.Estimate 8.
2.Damp 5. 8.	3.Informed 6. 9.	
3.Wet 6. 9.	Information Code 1 Owner	
		1.Owner 4.Agent 7.
		2.Relative 5.Estimate 8.
		3.Tenant 6.Other 9.

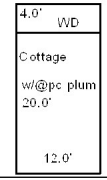
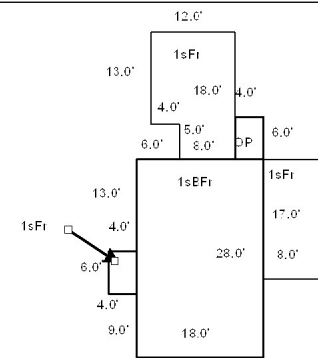

Date Inspected 8/15/1991

Additions, Outbuildings & Improvements

Type	Year	Units	Grade	Cond	Phys.	Funct.	Sound Value
1 One Story Frame	0	24	0 0	0	0 %	0 %	
1 One Story Frame	0	196	0 0	0	0 %	0 %	
1 One Story Frame	0	136	0 0	0	0 %	0 %	
21 Open Frame	0	24	0 0	0	0 %	0 %	
68 Wood Deck	0	48	0 0	0	0 %	0 %	
82 Cottage	0	240	0 0	0	0 %	0 %	
77 Plumbing Fixture	0	2	0 0	0	0 %	0 %	
					%	%	
					%	%	
					%	%	

- 1.One Story Fram
- 2.Two Story Fram
- 3.Three Story Fr
- 4.1 & 1/2 Story
- 5.1 & 3/4 Story
- 6.2 & 1/2 Story
- 21.Open Frame Por
- 22.Encl Frame Por
- 23.Frame Garage
- 24.Frame Shed
- 25.Finished 1/2 S
- 26.1SFr Overhang
- 27.Unfin Basement
- 28.Unfinished Att
- 29.Finished Attic

PINKHAM, PATRICIA
P.O. BOX 171
SEAL COVE, ME 04674 0171

B2234P96

Inspection Witnessed By:

X _____ Date _____

No./Date	Description	Date Insp.

Notes:

Southwest Harbor

Property Data			Assessment Record				
Neighborhood 1 Neighborhood 1			Year	Land	Buildings	Exempt	Total
Tree Growth Year 0			2007	39,200	0	0	39,200
X Coordinate 0			2008	39,200	0	0	39,200
Y Coordinate 0			2009	39,200	0	0	39,200
Zone/Land Use 11 Residential 1			2010	33,300	0	0	33,300
Secondary Zone			2011	33,300	0	0	33,300
Topography 2 Rolling			2012	29,400	0	0	29,400
1.Level 4.Below St 7.Rough			2013	29,400	0	0	29,400
2.Rolling 5.Low 8.			2014	29,400	0	0	29,400
3.Above St 6.Swampy 9.			2015	29,400	0	0	29,400
Utilities 9 None			2016	29,400	0	0	29,400
1.Summer Wtr 4.Dr Well 7.Septic			2017	29,400	0	0	29,400
2.Water 5.Dug Well 8.Spring			2018	29,400	0	0	29,400
3.Sewer 6.Lake Wtr 9.None			2019	29,400	0	0	29,400
Street 3 Gravel			2020	29,400	0	0	29,400
1.Paved 4.Proposed 7.			Land Data				
2.Semi Imp 5. 8.							
3.Gravel 6. 9.None			Front Foot				
TG PLAN YEAR 7							
Sale Date			Square Foot				
Price							
Sale Type			Fract. Acre				
1.Land 4.Mobile 7.C/I L&B							
2.L & B 5.Other 8.			Acres				
3.Building 6.C/I Land 9.							
Financing			Acres				
1.Convent 4.Seller 7.							
2.FHA/VA 5.Private 8.			Acres				
3.Assumed 6.Cash 9.Unknown							
Validity			Acres				
1.Valid 4.Split 7.Renovate							
2.Related 5.Partial 8.Other			Acres				
3.Distress 6.Exempt 9.							
Verified			Acres				
1.Buyer 4.Agent 7.Family							
2.Seller 5.Pub Rec 8.Other			Acres				
3.Lender 6.MLS 9.							

Type	Effective		Influence		Influence Codes
	Frontage	Depth	Factor	Code	
11.Regular Lot			%		1.Use
12.Delta Triangle			%		2.R/W
13.Nabla Triangle			%		3.Topography
14.Rear Land			%		4.Size/Shape
15.Miscellaneous			%		5.Access
			%		6.Restriction
			%		7.Vacancy
			%		8.Semi-improved
			%		9.Fract Share
			%		Acres
			%		30.Rear Land 3
			%		31.Rear Land 4
			%		32.Pasture
			%		33.Crop
			%		34.Hortical I
			%		35.Hortical II
			%		36.Orchard
			%		37.Softwood
			%		38.Mixed Wood
			%		39.Hardwood
			%		40.Wasteland
			%		41.Gravel Pit
			%		42.Mobile Home Si
			%		43.Condo Site
			%		44.Lot Improvemen
			%		45.Mobile Home Ho
			%		46.Golf Course

Total Acreage 3.20

Southwest Harbor

Map Lot 020-020-002

Account 691

Location 32 PORK CHOP LANE

Card 1 Of 1 10/28/2020

Building Style	SF Bsmt Living	Layout
1.Conv. 5.Colonial 9.Other	Fin Bsmt Grade	1.Typical 4. 7.
2.Ranch 6.Split 10.	OPEN 5 OPTIONAL	2.Inadeq 5. 8.
3.R Ranch 7.Contemp 11.	Heat Type 100%	3. 6. 9.
4.Cape 8.Cottage 12.	1.HWBB 5.FWA 9.No Heat	Attic
Dwelling Units	2.HWCI 6.GravWA 10.	1.1/4 Fin 4.Full Fin 7.
Other Units	3.H Pump 7.Electric 11.	2.1/2 Fin 5.F/Stair 8.
Stories	4.Radiant 8.F/Wall 12.	3.3/4 Fin 6. 9.None
1.1 4.1.5 7.3.5	Cool Type 0%	Insulation
2.2 5.1.75 8.4	1.Refrig 4.W&C Air 7.	1.Full 4.Minimal 7.
3.3 6.2.5 9.	2.Evapor 5. 8.	2.Heavy 5. 8.
Exterior Walls	3.H Pump 6. 9.None	3.Capped 6. 9.None
1.Wood 5.Shingle 9.Other	Kitchen Style	Unfinished %
2.Vinyl 6.Brick/St 10.Alum	1.Modern 4.Obsolete 7.	Grade & Factor
3.Compos. 7.Single 11.Log	2.Typical 5. 8.	1.E Grade 4.B Grade 7.3A Grade
4.Asbestos 8.Concrete 12.Stone	3.Old Type 6. 9.None	2.D Grade 5.A Grade 8.M&S Grad
Roof Surface	Bath(s) Style	3.C Grade 6.AA Grade 9.Same
1.Asphalt 4.Composit 7.Rolled R	1.Modern 4.Obsolete 7.	SQFT (Footprint)
2.Slate 5.Wood 8.	2.Typical 5. 8.	Condition
3.Metal 6.Other 9.	3.Old Type 6. 9.None	1.Poor 4.Avg 7.V G
SF Masonry Trim	# Rooms	2.Fair 5.Avg+ 8.Exc
OPEN-3-CUSTOM	# Bedrooms	3.Avg- 6.Good 9.Same
OPEN-4-CUSTOM	# Full Baths	Phys. % Good
Year Built	# Half Baths	Funct. % Good
Year Remodeled	# Addn Fixtures	Functional Code
Foundation	# Fireplaces	1.Incomp 4.Plb/Ht 7.
1.Concrete 4.Wood 7.		2.O-Built 5. 8.FractShr
2.C Block 5.Slab 8.		3.Style 6. 9.None
3.Br/Stone 6.Piers 9.		Econ. % Good
Basement		Economic Code
1.1/4 Bmt 4.Full Bmt 7.		0.None 3.No Power 7.
2.1/2 Bmt 5.Crawl 8.		1.Location 9.None 8.
3.3/4 Bmt 6. 9.None		2.Encroach 6. 9.
Bsmt Gar # Cars		Entrance Code 0
Wet Basement		1.Interior 4.Vacant 7.
1.Dry 4.Dirt Flo 7.		2.Refusal 5.Estimate 8.
2.Damp 5. 8.	3.Informed 6. 9.	
3.Wet 6. 9.	Information Code 0	
	1.Owner 4.Agent 7.	
	2.Relative 5.Estimate 8.	
	3.Tenant 6.Other 9.	

Date Inspected

Additions, Outbuildings & Improvements

Type	Year	Units	Grade	Cond	Phys.	Funct.	Sound Value
					%	%	1.One Story Fram
					%	%	2.Two Story Fram
					%	%	3.Three Story Fr
					%	%	4.1 & 1/2 Story
					%	%	5.1 & 3/4 Story
					%	%	6.2 & 1/2 Story
					%	%	21.Open Frame Por
					%	%	22.Encl Frame Por
					%	%	23.Frame Garage
					%	%	24.Frame Shed
					%	%	25.Finished 1/2 S
					%	%	26.1SFr Overhang
					%	%	27.Unfin Basement
					%	%	28.Unfinished Att
					%	%	29.Finished Attic

Southwest Harbor

Map Lot 020-020-003

Account 34

Location 44 PORK CHOP LANE

Card 1 Of 1 10/28/2020

Building Style 1 Conventional	SF Bsmt Living 0	Layout 1 Typical
1.Conv. 5.Colonial 9.Other	Fin Bsmt Grade 0 0	1.Typical 4. 7.
2.Ranch 6.Split 10.	OPEN 5 OPTIONAL 0	2.Inadeq 5. 8.
3.R Ranch 7.Contemp 11.	Heat Type 100% 5 Forced Warm Air	3. 6. 9.
4.Cape 8.Cottage 12.	1.HWBB 5.FWA 9.No Heat	Attic 9 None
Dwelling Units 1	2.HWCI 6.GravWA 10.	1.1/4 Fin 4.Full Fin 7.
Other Units 0	3.H Pump 7.Electric 11.	2.1/2 Fin 5.F/Stair 8.
Stories 4 One & 1/2 Story	4.Radiant 8.F/Wall 12.	3.3/4 Fin 6. 9.None
1.1 4.1.5 7.3.5	Cool Type 0% 9 None	Insulation 1 Full
2.2 5.1.75 8.4	1.Refrig 4.W&C Air 7.	1.Full 4.Minimal 7.
3.3 6.2.5 9.	2.Evapor 5. 8.	2.Heavy 5. 8.
Exterior Walls 5 Shingle	3.H Pump 6. 9.None	3.Capped 6. 9.None
1.Wood 5.Shingle 9.Other	Kitchen Style 2 Typical	Unfinished % 0%
2.Vinyl 6.Brick/St 10.Alum	1.Modern 4.Obsolete 7.	Grade & Factor 2 D 110%
3.Compos. 7.Single 11.Log	2.Typical 5. 8.	1.E Grade 4.B Grade 7.3A Grade
4.Asbestos 8.Concrete 12.Stone	3.Old Type 6. 9.None	2.D Grade 5.A Grade 8.M&S Grad
Roof Surface 1 Asphalt Shingles	Bath(s) Style 2 Typical Bath(s)	3.C Grade 6.AA Grade 9.Same
1.Asphalt 4.Composit 7.Rolled R	1.Modern 4.Obsolete 7.	SQFT (Footprint) 580
2.Slate 5.Wood 8.	2.Typical 5. 8.	Condition 4 Average
3.Metal 6.Other 9.	3.Old Type 6. 9.None	1.Poor 4.Avg 7.V G
SF Masonry Trim 0	# Rooms 4	2.Fair 5.Avg+ 8.Exc
OPEN-3-CUSTOM 0	# Bedrooms 2	3.Avg- 6.Good 9.Same
OPEN-4-CUSTOM 0	# Full Baths 1	Phys. % Good 0%
Year Built 1975	# Half Baths 0	Funct. % Good 100%
Year Remodeled 0	# Addn Fixtures 0	Functional Code 9 None
Foundation 2 Concrete Block	# Fireplaces 1	1.Incomp 4.Plb/Ht 7.
1.Concrete 4.Wood 7.		2.O-Built 5. 8.FractShr
2.C Block 5.Slab 8.		3.Style 6. 9.None
3.Br/Stone 6.Piers 9.		Econ. % Good 100%
Basement 9 No Basement		Economic Code None
1.1/4 Bmt 4.Full Bmt 7.		0.None 3.No Power 7.
2.1/2 Bmt 5.Crawl 8.		1.Location 9.None 8.
3.3/4 Bmt 6. 9.None		2.Encroach 6. 9.
Bsmt Gar # Cars 0		Entrance Code 3 Information Only
Wet Basement 9 No Basement		1.Interior 4.Vacant 7.
1.Dry 4.Dirt Flo 7.		2.Refusal 5.Estimate 8.
2.Damp 5. 8.		3.Informed 6. 9.
3.Wet 6. 9.		Information Code 1 Owner
		1.Owner 4.Agent 7.
		2.Relative 5.Estimate 8.
		3.Tenant 6.Other 9.

Date Inspected 8/15/1991

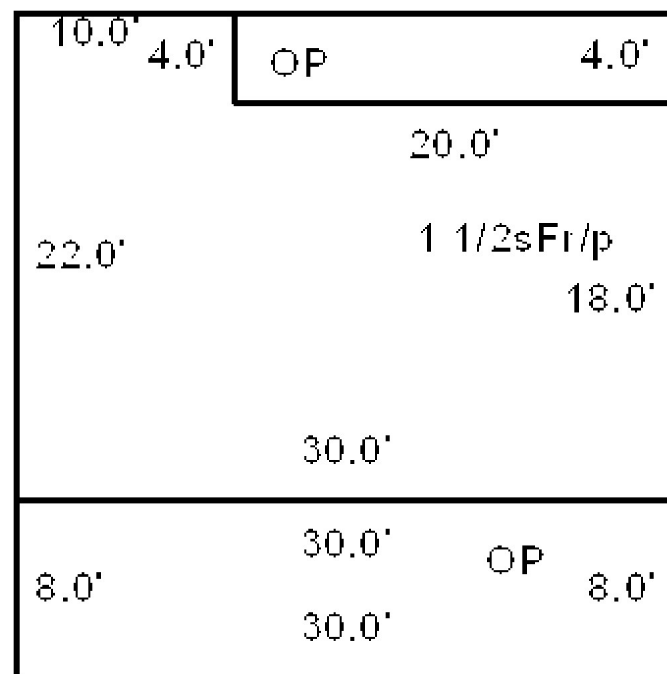

Additions, Outbuildings & Improvements

Type	Year	Units	Grade	Cond	Phys.	Funct.	Sound Value
21 Open Frame	0	80	0 0	0	0 %	0 %	
21 Open Frame	0	240	0 0	0	0 %	0 %	
					%	%	
					%	%	
					%	%	
					%	%	
					%	%	
					%	%	
					%	%	
					%	%	
					%	%	

- 1.One Story Fram
- 2.Two Story Fram
- 3.Three Story Fr
- 4.1 & 1/2 Story
- 5.1 & 3/4 Story
- 6.2 & 1/2 Story
- 21.Open Frame Por
- 22.Encl Frame Por
- 23.Frame Garage
- 24.Frame Shed
- 25.Finished 1/2 S
- 26.1SFr Overhang
- 27.Unfin Basement
- 28.Unfinished Att
- 29.Finished Attic

Southwest Harbor

Map Lot 020-021

Account 519

Location

Card 1 Of 1 10/28/2020

Building Style	SF Bsmt Living	Layout
1.Conv. 5.Colonial 9.Other	Fin Bsmt Grade	1.Typical 4. 7.
2.Ranch 6.Split 10.	OPEN 5 OPTIONAL	2.Inadeq 5. 8.
3.R Ranch 7.Contemp 11.	Heat Type 100%	3. 6. 9.
4.Cape 8.Cottage 12.	1.HWBB 5.FWA 9.No Heat	Attic
Dwelling Units	2.HWCI 6.GravWA 10.	1.1/4 Fin 4.Full Fin 7.
Other Units	3.H Pump 7.Electric 11.	2.1/2 Fin 5.F/Stair 8.
Stories	4.Radiant 8.F/Wall 12.	3.3/4 Fin 6. 9.None
1.1 4.1.5 7.3.5	Cool Type 0%	Insulation
2.2 5.1.75 8.4	1.Refrig 4.W&C Air 7.	1.Full 4.Minimal 7.
3.3 6.2.5 9.	2.Evapor 5. 8.	2.Heavy 5. 8.
Exterior Walls	3.H Pump 6. 9.None	3.Capped 6. 9.None
1.Wood 5.Shingle 9.Other	Kitchen Style	Unfinished %
2.Vinyl 6.Brick/St 10.Alum	1.Modern 4.Obsolete 7.	Grade & Factor
3.Compos. 7.Single 11.Log	2.Typical 5. 8.	1.E Grade 4.B Grade 7.3A Grade
4.Asbestos 8.Concrete 12.Stone	3.Old Type 6. 9.None	2.D Grade 5.A Grade 8.M&S Grad
Roof Surface	Bath(s) Style	3.C Grade 6.AA Grade 9.Same
1.Asphalt 4.Composit 7.Rolled R	1.Modern 4.Obsolete 7.	SQFT (Footprint)
2.Slate 5.Wood 8.	2.Typical 5. 8.	Condition
3.Metal 6.Other 9.	3.Old Type 6. 9.None	1.Poor 4.Avg 7.V G
SF Masonry Trim	# Rooms	2.Fair 5.Avg+ 8.Exc
OPEN-3-CUSTOM	# Bedrooms	3.Avg- 6.Good 9.Same
OPEN-4-CUSTOM	# Full Baths	Phys. % Good
Year Built	# Half Baths	Funct. % Good
Year Remodeled	# Addn Fixtures	Functional Code
Foundation	# Fireplaces	1.Incomp 4.Plb/Ht 7.
1.Concrete 4.Wood 7.		2.O-Built 5. 8.FractShr
2.C Block 5.Slab 8.		3.Style 6. 9.None
3.Br/Stone 6.Piers 9.		Econ. % Good
Basement		Economic Code
1.1/4 Bmt 4.Full Bmt 7.		0.None 3.No Power 7.
2.1/2 Bmt 5.Crawl 8.		1.Location 9.None 8.
3.3/4 Bmt 6. 9.None		2.Encroach 6. 9.
Bsmt Gar # Cars		Entrance Code 0
Wet Basement		1.Interior 4.Vacant 7.
1.Dry 4.Dirt Flo 7.		2.Refusal 5.Estimate 8.
2.Damp 5. 8.	3.Informed 6. 9.	
3.Wet 6. 9.	Information Code 0	
	1.Owner 4.Agent 7.	
	2.Relative 5.Estimate 8.	
	3.Tenant 6.Other 9.	

Date Inspected

Additions, Outbuildings & Improvements

Type	Year	Units	Grade	Cond	Phys.	Funct.	Sound Value
					%	%	1.One Story Fram
					%	%	2.Two Story Fram
					%	%	3.Three Story Fr
					%	%	4.1 & 1/2 Story
					%	%	5.1 & 3/4 Story
					%	%	6.2 & 1/2 Story
					%	%	21.Open Frame Por
					%	%	22.Encl Frame Por
					%	%	23.Frame Garage
					%	%	24.Frame Shed
					%	%	25.Finished 1/2 S
					%	%	26.1SFr Overhang
					%	%	27.Unfin Basement
					%	%	28.Unfinished Att
					%	%	29.Finished Attic